



# PRE-SEASON CHECKUP

**6-9 TON GEN 1 METERING SYSTEM**

# METER (GEN 1)

- Inspect all drive sprockets, chains, and bearings for wear. Damaged or worn parts should be replaced.

REPLACEMENT AUGER DRIVE COMPONENTS			
ID	PART #	DESCRIPTION	APPLICATION
A	K003178	KIT – DRIVE REBUILD COMPLETE (HEX-DRIVE AUGER)	8-12 ROW (1 SECTION HEX DRIVE AUGER)
B	K003179	KIT – DRIVE REBUILD COMPLETE (HEX-DRIVE AUGER)	16-24 ROW (1 SECTION HEX DRIVE AUGER)
C	K003180	KIT – DRIVE REBUILD COMPLETE (HEX-DRIVE AUGER)	16-24 ROW (2 SECTION – 2 FULL HEX-DRIVE AUGERS)
D	K003181	KIT – DRIVE REBUILD COMPLETE (HEX-DRIVE AUGER)	16-24 ROW (2 SECTION – 4 HALF HEX-DRIVE AUGERS)
E	M000178	CAP – 2" ORANGE W/ HOLE	CHECK VALVE CAP
F	M000184	BEARING - 62 MM AUGER BLACK NYLON	HO (2.5") OUTPUT
G	M000185	BEARING - 52 MM AUGER BLACK NYLON	STD (2") OUTPUT
H	M000602	CHAIN - SINGLE AUGER DRIVE	8-12 ROW
I	M000603	CHAIN - TWIN AUGER DRIVE	16-24 ROW (4 HALF AUGERS)
J	M002753	BEARING - SECTION CONTROL BLOCK 2-1/2" (HO)	16, 24 ROW; HO; 2 SECTION (4 HALF AUGERS)
K	M005384	CHAIN – TWIN AUGER DRIVE (2 SECTION)	16, 24 ROW (2 FULL AUGERS)
L	P000161	BALL – AIR CHECK	CHECK VALVE BALL
M	P000214	BEARING FLANGE – 52 MM AUGER	STD (2") OUTPUT
N	P000215	BEARING FLANGE – 62 MM AUGER	HO (2.5") OUTPUT
O	P000217	CHAIN LINK- #40 S/S CONNECTING	
P	P000219	SPROCKET - #40 IDLER 17 TOOTH IDLER 1/2" BORE	
Q	P000220	SPROCKET - #40 14 TOOTH 1" BORE	
R	P000580	SPROCKET - #40 22 TOOTH 1.004 BORE	ROUND SHAFT DRIVE AUGERS
S	P002081	SPROCKET - #40 22 TOOTH HEX BORE	*HEX SHAFT DRIVE AUGERS
T	W000076	SPROCKET – ENCODER (RAVEN)	FOR OLD RAVEN 5 VOLT 36 PULSE ENCODER

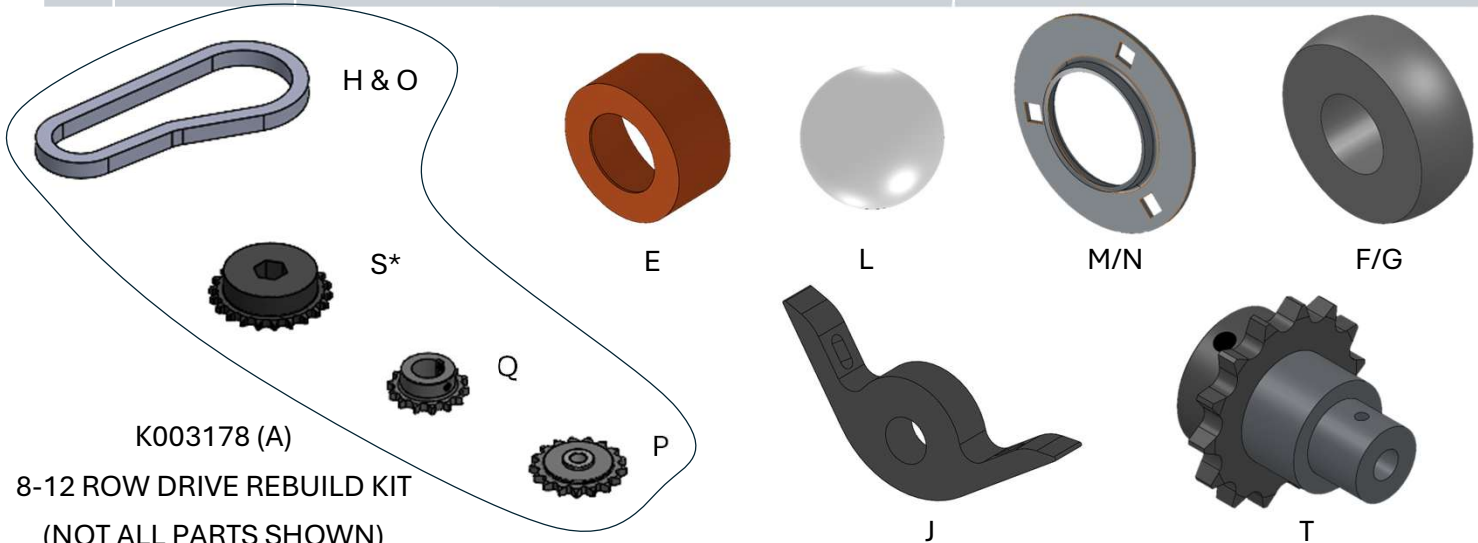

FOR PRICING, SEE PRICE GUIDE OR ORDER FORM.

UNLESS OTHERWISE NOTED, ALL PARTS IN THIS PRE-SEASON CHECKUP HAVE A 1 YEAR PARTS WARRANTY.

# METER (GEN 1)

## HYDRAULIC DRIVE

- Refer to the QR code below for looking up hydraulic motors and sensors for your Montag metering system.



## METER REBUILD OPTIONS

- For older Montag Gen 1 meters where the meter needs replacement due to rust, age, and/or wear, there are some options to rebuild the meter and have a reliable machine for years to come.

ID	PART #	DESCRIPTION	DETAILS
A	REFER TO QR CODE BELOW FOR QUOTE TOOL AND PROGRAM DETAILS	BASIC METER REPLACEMENT	MONTAG CAN SHIP PARTS TO DEALERSHIP TO REPLACE METER.
B		FACTORY REBUILD	MACHINE REBUILT IN FACTORY. OPTIONS INCLUDE: REPLACE METER, CHANGE ROW OUTPUTS, UPGRADE TO CRARY FAN, REPLACE AUGERS, UPGRADE OR REPLACE HYDRAULICS, ADD SECTION CONTROL, ETC

**FACTORY WARRANTY**



**UPGRADE OPTIONS**



**SAVE MONEY**  
(VERSES TRADING IN MACHINE)



FOR PRICING, SEE PRICE GUIDE OR ORDER FORM.

UNLESS OTHERWISE NOTED, ALL PARTS IN THIS PRE-SEASON CHECKUP HAVE A 1 YEAR PARTS WARRANTY.

# METER (GEN 1) SECTION CONTROL

- Section control allows for more efficient fertilizer placement.
- 16 and 24 row machines can be upgraded from 1 to 2 sections.
- For Model Year 2021 (SN 21643), Montag updated the auger motor from a 60 pulse to a 30 pulse motor. Verify that you purchase the correct upgrade kit for the serial number of your machine.
- Customer is responsible for verifying that their harnessing supports section control. A new harness may be required.

FRONT/BACK METER SPLIT (USES EXISTING AUGERS)	SECTION CONTROL UPGRADE KITS				
	PART #	ROWS	OUTPUT	SERIAL #	AUGER MOTOR ENCODER
	K003034	16	2”	-21639	60 PULSE
	K003036	16	2”	21643+	30 PULSE
	K003029	16	2.5”	-21639	60 PULSE
	K003031	16	2.5”	21643+	30 PULSE
	K003035	24	2”	-21639	60 PULSE
	K003037	24	2”	21643+	30 PULSE
	K003030	24	2.5”	-21639	60 PULSE
	K003032	24	2.5”	21643+	30 PULSE

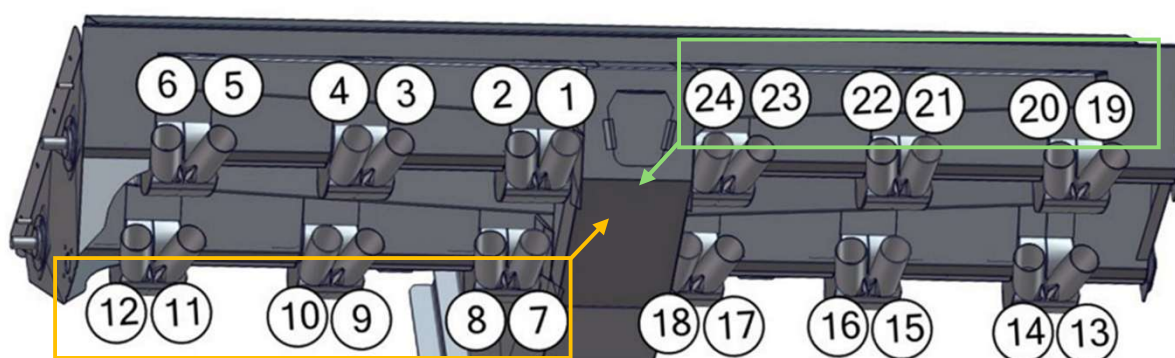

WHEN USING A **FRONT/BACK** SPLIT 2 SECTION UPGRADE KIT, THESE HOSE LOCATIONS WILL NEED TO BE SWAPPED.

K003032  
(REPRESENTS FRONT/BACK  
SECTION CONTROL KIT)

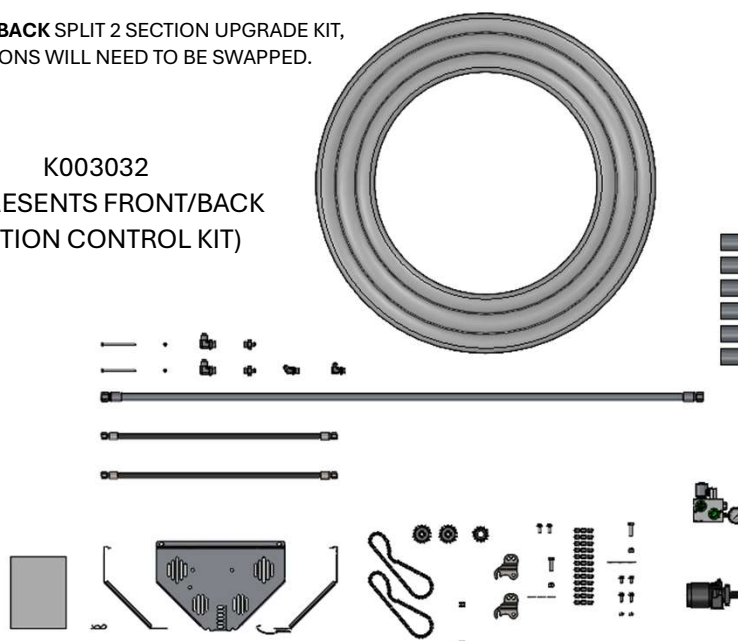

FOR PRICING, SEE PRICE GUIDE OR ORDER FORM.

UNLESS OTHERWISE NOTED, ALL PARTS IN THIS PRE-SEASON CHECKUP HAVE A 1 YEAR PARTS WARRANTY.



# SCALE & LID

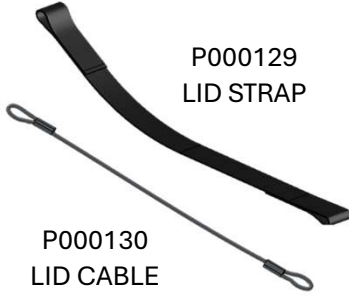

LID SERVICE ITEMS	
PART #	DESCRIPTION
P000129	LID STRAP
P000130	LID CABLE
P000553	LID LATCH (2011-PRESENT)

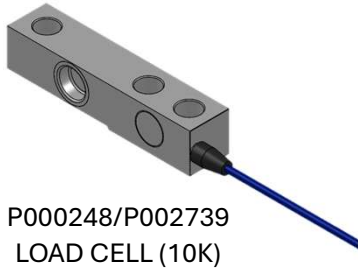

SCALE SERVICE ITEMS	
PART #	DESCRIPTION
P000248	LOAD CELL (10K) W/ FLYING LEAD (19')
P000455	HARNESS – JOHN DEERE ISOBUS JUMPER
P002732	BLOCK – DT 6 PIN, 7 PORT JUNCTION
P002739	LOAD CELL (10K) W/ DT 6 PIN CONNECTOR (14')

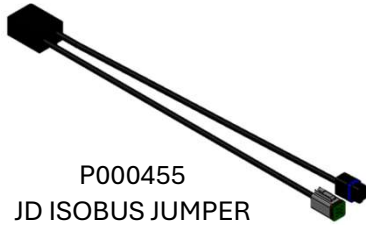

- Check scale function to ensure that all load cells and connectors are functioning correctly.
- If scales are bouncing or erratic, unplug all load cells and plug in individually to see which one is causing the errors.
- If the scales are not pulling up on the ISOBUS, make sure that the harness from the scale to the dry controller is connected securely and clean.
- Only use air or electric contact cleaner to clean connections. Dielectric grease will cause scales to read erratically and may void load cell warranty if used.

## SCALE UPGRADE OPTIONS

- For MY 2023, Montag released the Point ISO scale kit option. This scale kit has a digital display on the machine and allows the operator to manage their scale system from their phone via Bluetooth. It is also integrated into the Montag ISOBUS Dry Rate Controller (MDRC).
- A base K002163 load cell kit will also be required if machine does not already have scales.

KIT	DESCRIPTION
K002739AA	ISO POINT SCALE
K002745AA	JDRC ISO POINT SCALE



# PLATFORM & BIN

## FERTILIZER FILTERING SCREENS

PART #	DESCRIPTION
W000071	SCREEN - BIN TOP (1/2" C/C) (GEN 1)
W000160	SCREEN - BIN TOP (3/4" C/C) (GEN 1)

- Montag offers multiple screen sizes to filter out foreign material and clumps from the fertilizer.
- Broken or missing screens can cause plugging at knife from too large of particles.
- For higher flow and quicker filling speed, use W000160 with 3/4" square openings.
- For finer filtering, use W000071 with 1/2" square openings.

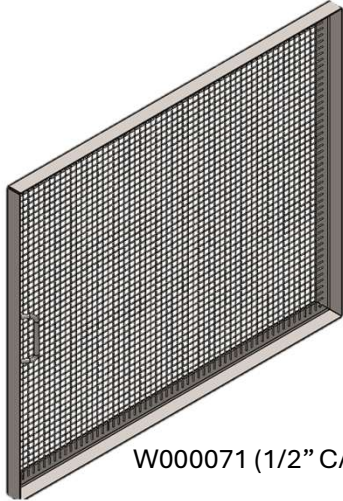

W000071 (1/2" C/C)

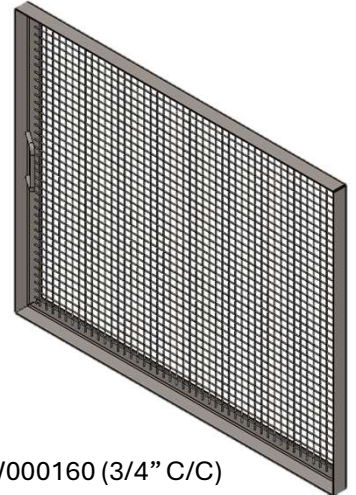

W000160 (3/4" C/C)

## PLATFORM OPTIONS

PART #	DESCRIPTION
A002458AA	DECK - UNIVERSAL ASSEMBLED
A002444AA	LADDER - 5 STEP FOLDING (6 TON)
A002448AA	LADDER - 6 STEP FOLDING (9 TON)
A002706AA	LADDER - 9 TON TANK HAND RAIL ASSEMBLY
A002707AA	LADDER - 6 TON TANK HAND RAIL ASSEMBLY

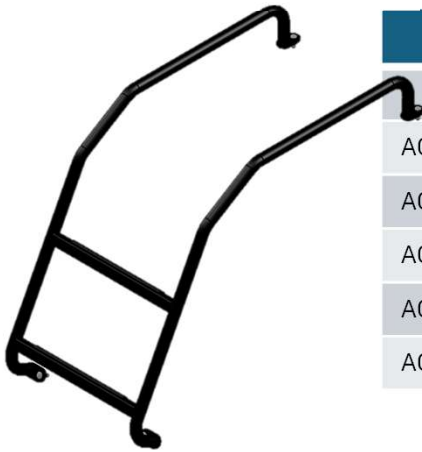

A002706AA  
9 TON TANK LADDER



A002707AA  
6 TON TANK LADDER

- Older machines did not ship with a hand-rail assembly on the tank.
- See A002444AA or A002448AA for ladder options.
- To replace or add a new platform, see A002458AA.
- Other platform parts are available on request to replace damaged or missing components.



A002458AA  
GEN 1 PLATFORM

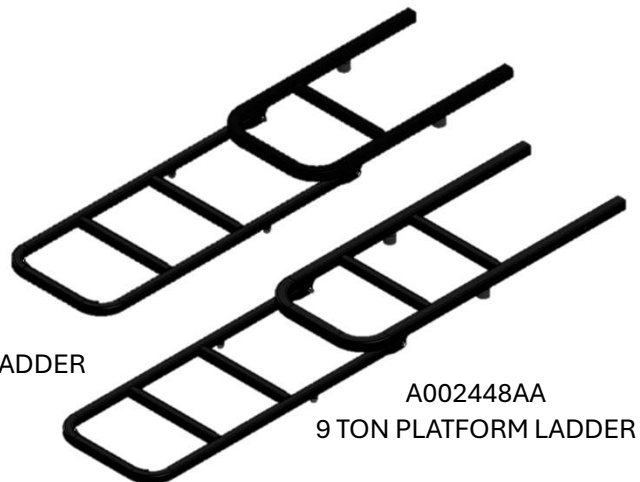

A002444AA  
6 TON PLATFORM LADDER

A002448AA  
9 TON PLATFORM LADDER

FOR PRICING, SEE PRICE GUIDE OR ORDER FORM.

UNLESS OTHERWISE NOTED, ALL PARTS IN THIS PRE-SEASON CHECKUP HAVE A 1 YEAR PARTS WARRANTY.

# BLOCKAGE MONITORING



P003074  
MONITOR – J.ASSY

BLOCKAGE MONITOR SERVICE ITEMS	
PART.#	DESCRIPTION
P003074	MONITOR – J.ASSY BLOCKAGE
P002447	REDUCER – 1.25” RUBBER
P002313	REDUCER – 1.5” RUBBER
P002311	REDUCER – 1.75” RUBBER
P002448	REDUCER – 2.0” RUBBER
P002460	SENSOR – 1.25” X 1.5” WIRELESS (FERTILIZER)
P002397	SENSOR – 1.5” X 1.5” WIRELESS (FERTILIZER)
P002308	SENSOR – 1.5” X 1.75” WIRELESS (FERTILIZER)
P002396	SENSOR – 1.75” X 1.75” WIRELESS (FERTILIZER)
P002715	SENSOR – 2.0” X 2.0” WIRELESS (FERTILIZER)



SENSOR - WIRELESS  
FERTILIZER BLOCKAGE



P002447  
REDUCER – 1.25”

- Blockage sensors are generally installed over the outlet of the air release and over the outside of the drop tube hose.
- The J.Assy wireless blockage monitoring system does not require wiring on the toolbar which greatly simplifies installation.

## BLOCKAGE MONITOR UPGRADE OPTIONS

- J-Assy Blockage Sensors enable the farmer to run with confidence that product is being applied at all rows.
- It is common for issues to arise that inhibit product from being applied on one or more rows. Product can plug the hoses, hoses can kink, shear couplers can break to protect a meter from damage, or hoses can come off of air the releases.

Scan QR Code to understand the benefits of J-Assy blockage monitors.



\*Blockage Sensor Kits listed include fertilizer sensors. Small grain and seed sensor kits are also available.

\*\*For Kuhn toolbars, please contact Kuhn to add a blockage monitoring system.

KIT*	ROWS	HOSE SIZE (A)	HOSE SIZE (B)
K002883	4	1-1/2”	1-1/2”
K002052	4	1-3/4”	1-1/2”
K002884	6	1-1/2”	1-1/2”
K002053	6	1-3/4”	1-1/2”
K002885	8	1-1/2”	1-1/2”
K002031	8	1-3/4”	1-1/2”
K002886	12	1-1/2”	1-1/2”
K002032	12	1-3/4”	1-1/2”
K002887	16	1-1/2”	1-1/2”
K002033	16	1-3/4”	1-1/2”
K002888	18	1-1/2”	1-1/2”
K002034	18	1-3/4”	1-1/2”
K002889	24	1-1/2”	1-1/2”
K002035	24	1-3/4”	1-1/2”

FOR PRICING, SEE PRICE GUIDE OR ORDER FORM.

ALL J-ASSY PARTS IN THIS PRE-SEASON CHECKUP HAVE A 2 YEAR PARTS WARRANTY.

# OTHER UPGRADES

## GPS GLOBE MOUNT (IMPLEMENT GUIDANCE)

- For the John Deere implement guidance globe, Montag has developed a bolt-on mount for Gen 1 machines.
  - Mount height is adjustable for both 6-ton and 9-ton Gen 1 machines.
  - Bolt-together design to minimize shipping cost.

KIT	DESCRIPTION
K003183AA	KIT – GPS GLOBE MOUNT (GEN 1)

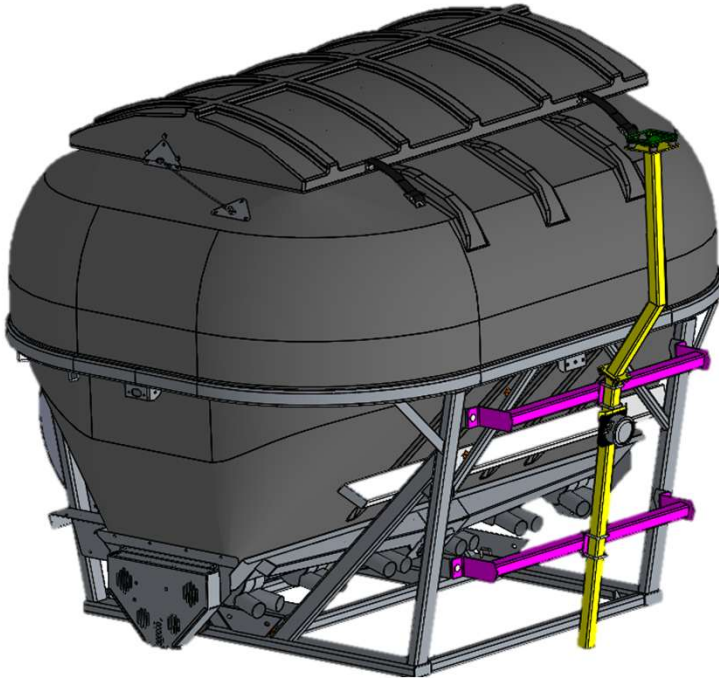

K003183AA  
KIT – GPS GLOBE MOUNT (GEN 1)

## MASTER SWITCH CONTROL



P002340  
FOOT SWITCH

KIT	DESCRIPTION
P002340	REMOTE FOOT PEDAL W/ 144" LEAD
K002504	IMPLEMENT SWITCH W/ 40" LEAD
P000376	HARNESS – 120" EXT. (FOOT & IMP)



K002504  
IMPLEMENT SWITCH

## CRARY FAN SCREEN CLEANER

- If you are having a problem with field debris getting stuck on the fan screen and inhibiting air flow, Montag offers a fan screen cleaner option for Gen 1 machines equipped with a Crary fan (MY 2022+).

KIT	DESCRIPTION
K002990	8-18 ROW (8" FAN) SCREEN CLEANER
K003054	24 ROW (10" FAN) SCREEN CLEANER





# OTHER UPGRADES

## BRAND PWM HYDRAULIC BLOCK UPGRADE

- Older machines (before Serial Number: S12177) with the black Brand PWM hydraulic valve can be upgraded to a modern PWM hydraulic block that offers better reliability and safety features.
- This will add case drain protection for the fan motor with a buzzer alert to prevent damage to the motor from case drain over pressurization.
- Purchase K000040 (See image)

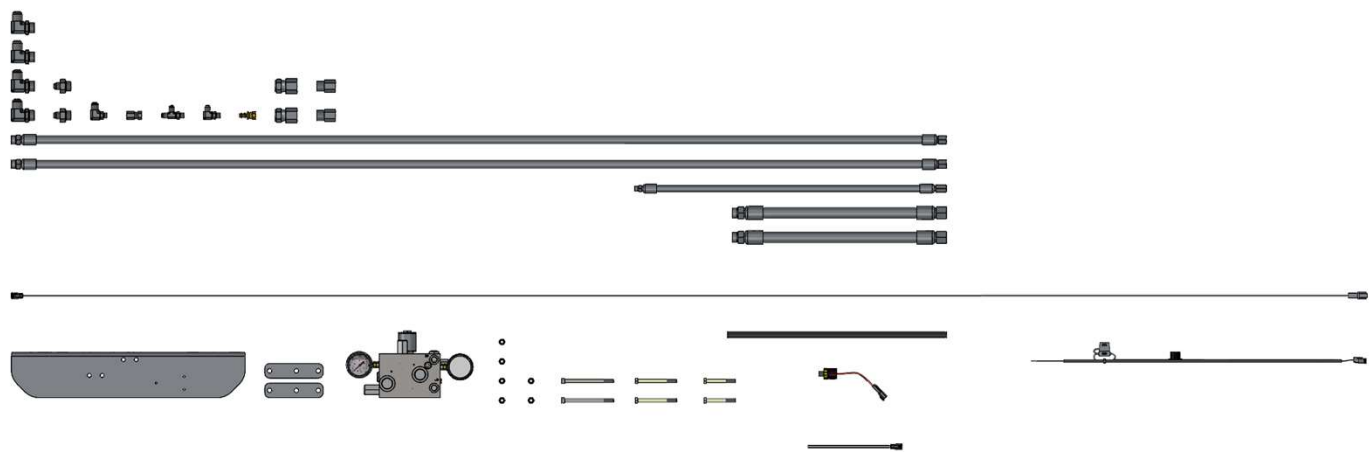

## POWER BEYOND HYDRAULIC UPGRADE

- Montag has recently released a hydraulic Power Beyond option for Montag metering systems.
- It is currently only available for Montag machines with a Montag Dry Rate Controller (MDRC).
- This is intended for applications where there are limited hydraulic SCV's available.
- This allows user to control fan speed via MDRC

KIT	DESCRIPTION
K002989AA	8-18 ROW (8" FAN) POWER-BEYOND
K003071AA	24 ROW (10" FAN) POWER-BEYOND

