

REVISIONS			
REV.	DESCRIPTION	DATE	APPROVAL
A	RELEASED FOR PRODUCTION	12/11/2017	IJM
B	DIVIDED PARTS INTO NEW KITS	12/14/2017	IJM
C	UPDATED LOWER LEVEL KITS	12/3/2020	IJM

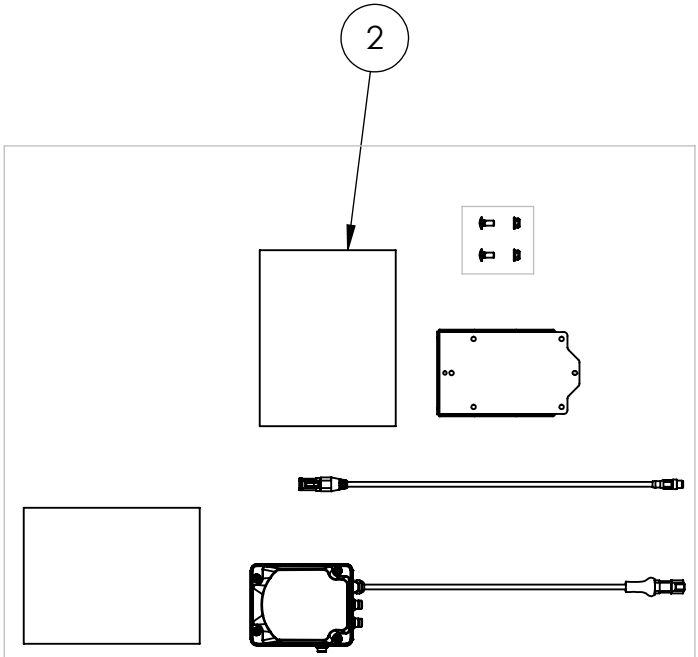
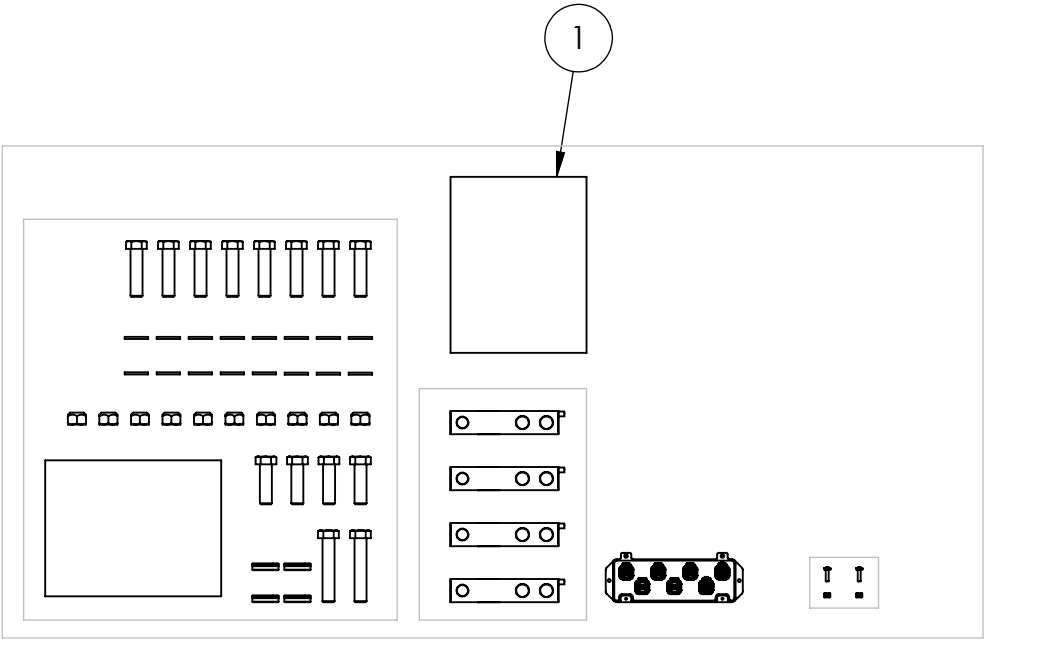

**MONTAG MFG**

3816 461st AVE,  
Emmetsburg, IA 50536

P: 712-852-4572  
F: 712-852-4574  
www.montagmfg.com

DO NOT SCALE DRAWING  
UNLESS OTHERWISE SPECIFIED:  
DIMENSIONS ARE IN INCHES

TOLERANCES ARE AS FOLLOWS:  
FRACTIONAL  $\pm 1/32$   
ANGULAR:  $\pm 1$   
TWO PLACE DECIMAL  $\pm .03$   
THREE PLACE DECIMAL  $\pm .003$

MATERIAL  
N/A

FINISH  
N/A

**CONFIDENTIAL:**  
This drawing and design is proprietary  
and confidential to Montag  
Manufacturing, Inc.

	NAME	DATE
DRAWN	SEC	12/08/17
APPROVED	IJM	12/07/20

COMMENTS:  
DT VERSION OF K002003  
PER ECR 120617IM2

TITLE:  
**Scale Kit - ISO DT 6 Pin  
Complete (4 Load Cell)**

SIZE PART. NO. REV  
**A K002156 C**

SCALE: 1:12 WEIGHT: 30.58 SHEET 1 OF 1

ITEM NO.	QTY.	PART NUMBER	DESCRIPTION
1	1	K002163	Scale Kit - Gen I Base DT 6 Pin
2	1	K002165	Scale Kit - ISO DT 6 Pin Add-On