

REVISIONS			
REV.	DESCRIPTION	DATE	APPROVAL
A	RELEASED FOR PRODUCTION	12/6/2017	IJM
B	SWITCHED BOLT P000852 WITH P000416	8/16/2018	IJM

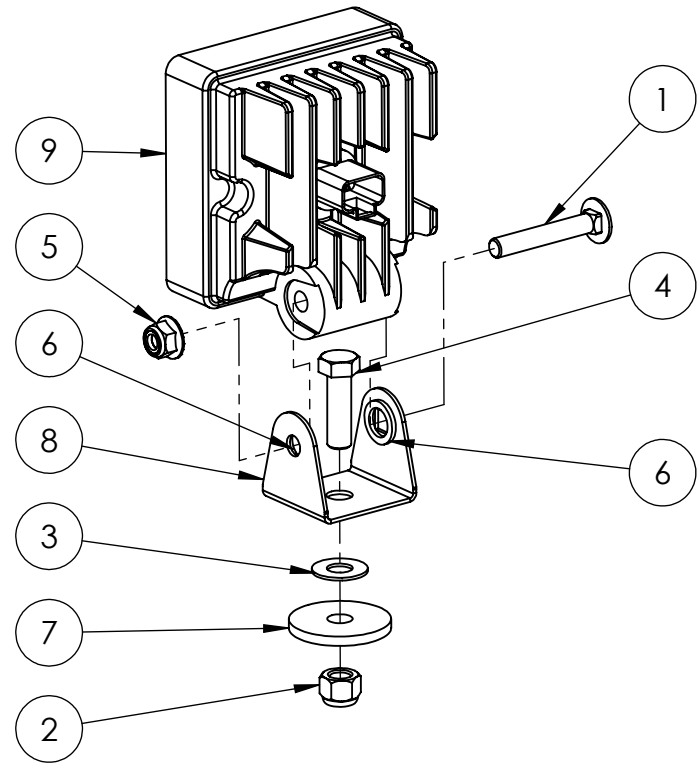

ITEM NO.	QTY.	PART NUMBER	DESCRIPTION
1	1	P000095	Bolt - 5/16-18 x 2 x 0.875 Carriage (F593 304 S/S FB)
2	1	P000105	Nut - 3/8-16 Hex Nylon Lock (F594 316 S/S FB)
3	1	P000111	Washer - 3/8" Flat (0.875" OD) (18-8 S/S FB)
4	1	P000416	Bolt - 3/8-16 x 1.25 x 1 Hex (F593 304 S/S FB)
5	1	P002224	Nut - 5/16-18 Flange Nylon Lock (18-8 S/S FB)
6	2	P002705	Washer - Work Light Mounting Bracket (Plastic)
7	1	P002706	Washer - Work Light Mounting Bracket (Rubber)
8	1	P002707	Bracket - Work Light Mount
9	1	P002738	Light - Cube LED Aux Work

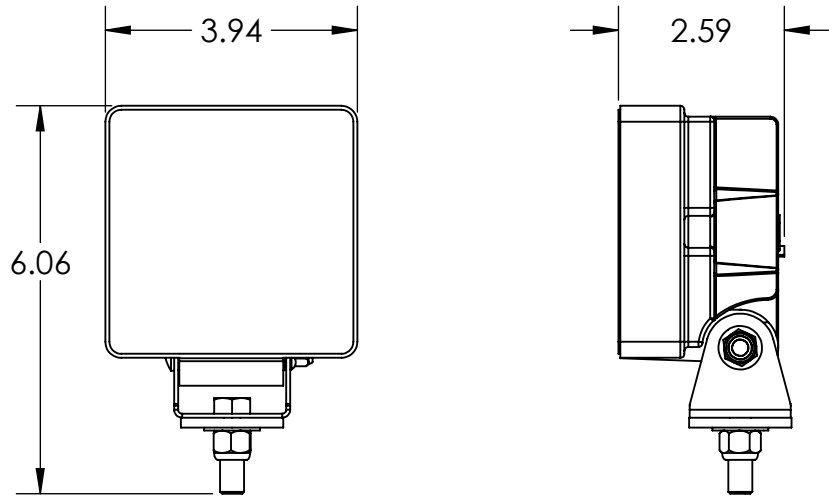

MONTAG MFG

3816 461st AVE,
Emmetsburg, IA 50536

P: 712-852-4572
F: 712-852-4574
www.montagmfg.com

DO NOT SCALE DRAWING
UNLESS OTHERWISE SPECIFIED:
DIMENSIONS ARE IN INCHES

TOLERANCES ARE AS FOLLOWS:
FRACTIONAL: ± 1/32
ANGULAR: ± 1°
TWO PLACE DECIMAL: ±.03
THREE PLACE DECIMAL: ±.003

MATERIAL N/A

FINISH N/A

CONFIDENTIAL:
This drawing and design is proprietary
and confidential to Montag
Manufacturing, Inc.

	NAME	DATE
DRAWN	SEC	10/27/17
APPROVED	SEC	02/01/21

COMMENTS:
Grote P/N: 63Y81-3

TITLE:
**Assembly - LED Work
Light (w/Mounting
Bracket)**

SIZE	PART. NO.	REV
A	P002189	B-01

SCALE: 1:3 WEIGHT: 2.91 SHEET 1 OF 1