

12- Row Gladiator Hose Routing For 6 Ton Montag Dry Fertilizer Skid

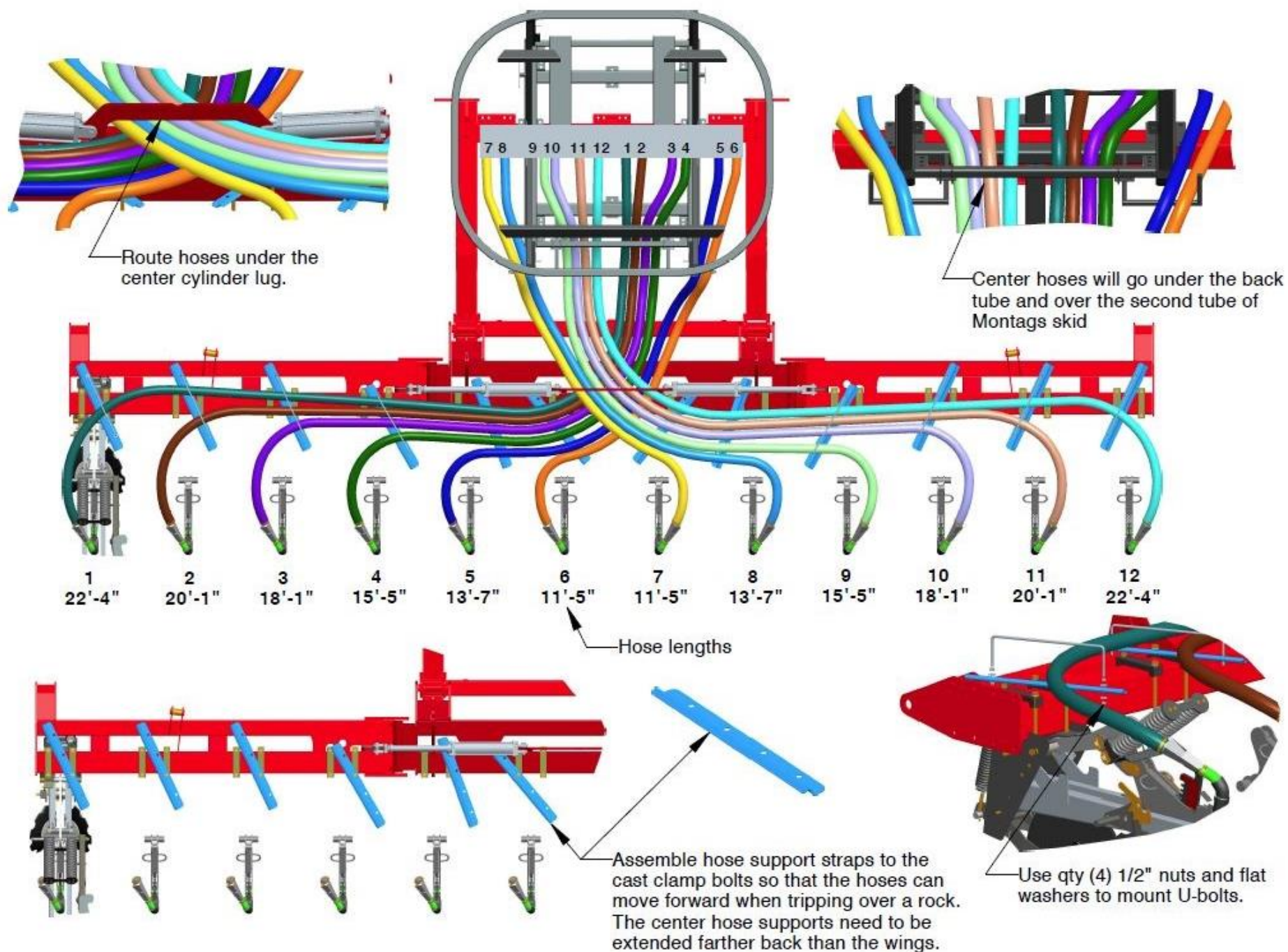

16- Row Gladiator Hose Routing For 6 Ton Montag Dry Fertilizer Skid

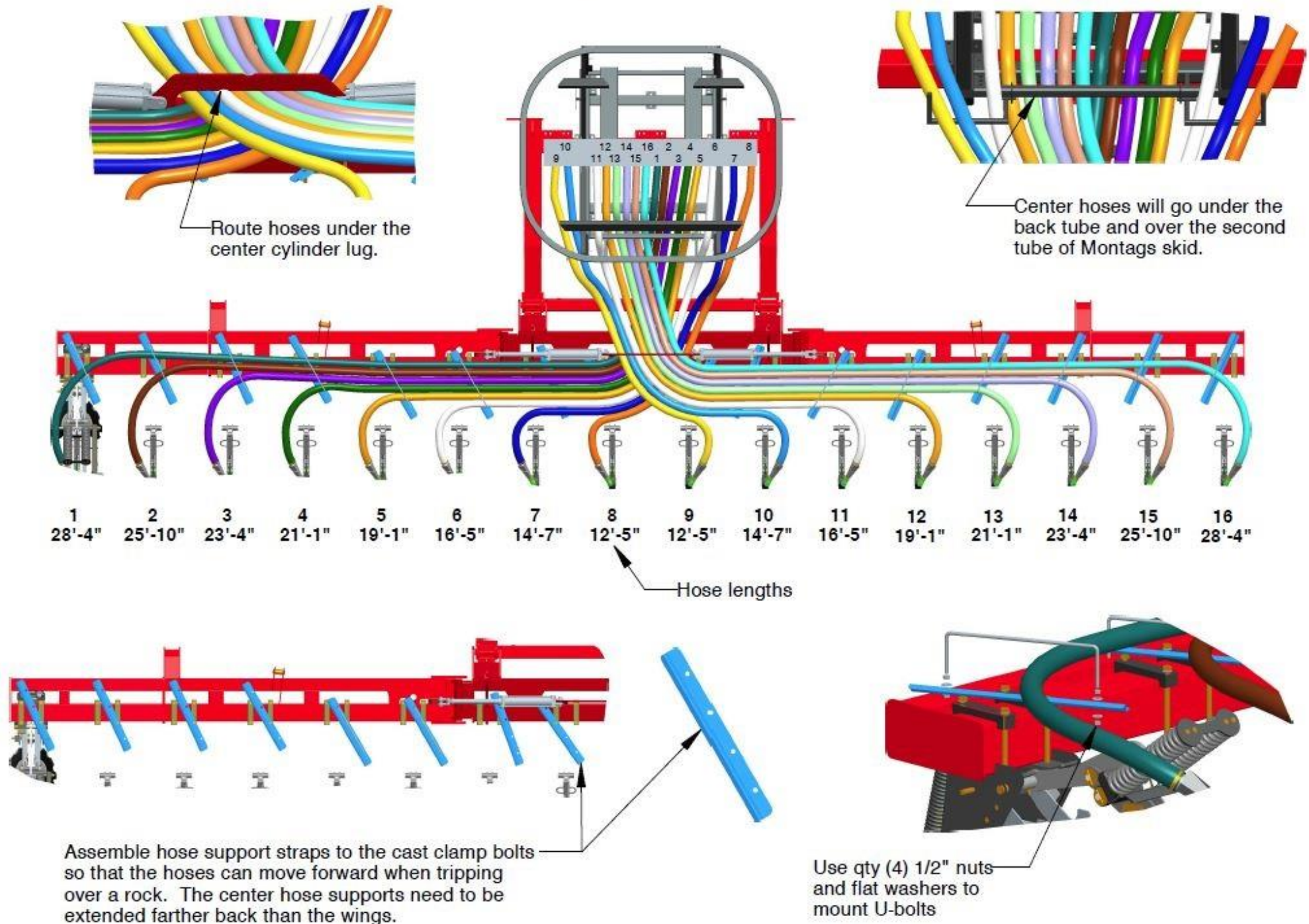

MonTag / Gladiator Row Unit Assembly Instructions

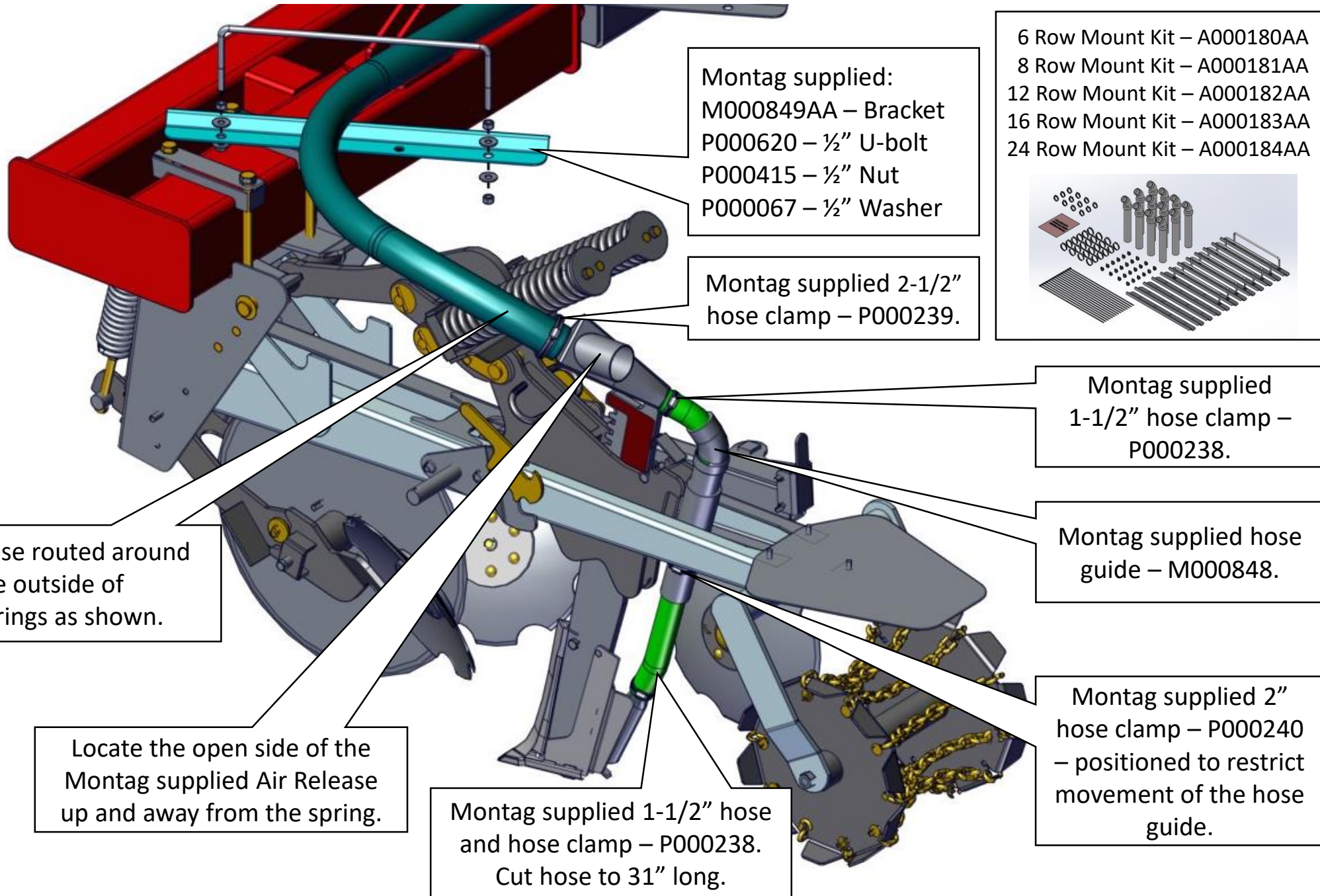

MonTag / J. Assy / Gladiator Blockage Sensor Assembly Instructions

Install couplers as shown. It is important to keep couplers in line with air release and hose as shown. Refer to J. Assy install guide for setup and programming of monitor and sensors.

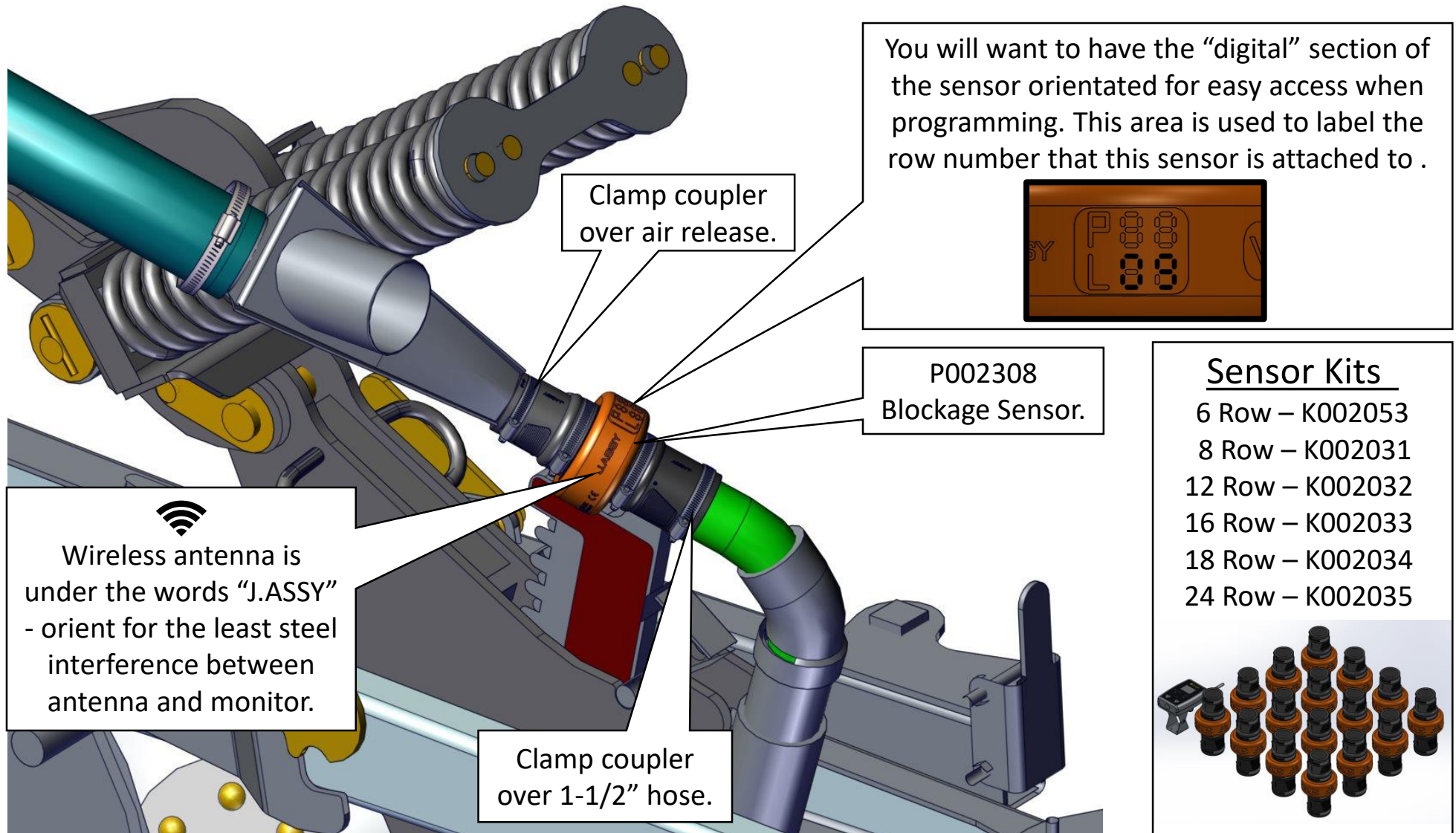

HYDRAULIC COMPONENTS FOR MONTAG GEN I DRY SKID*

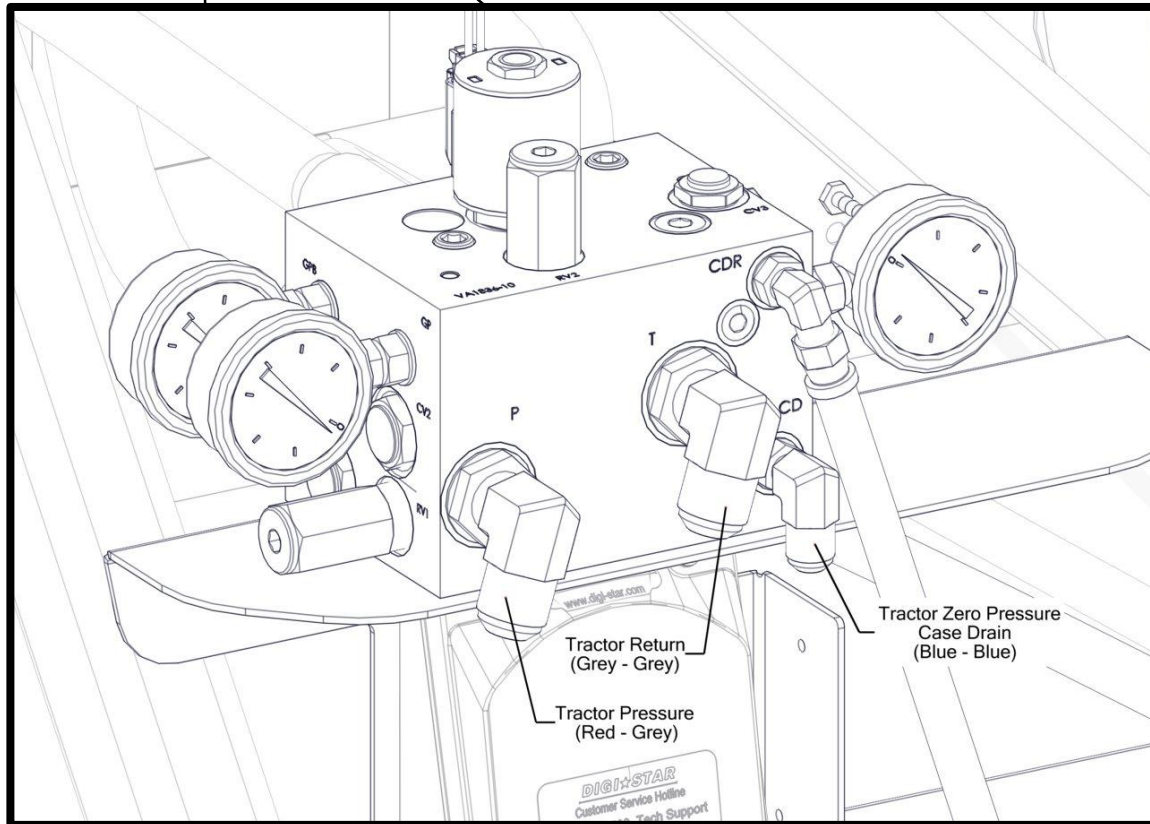
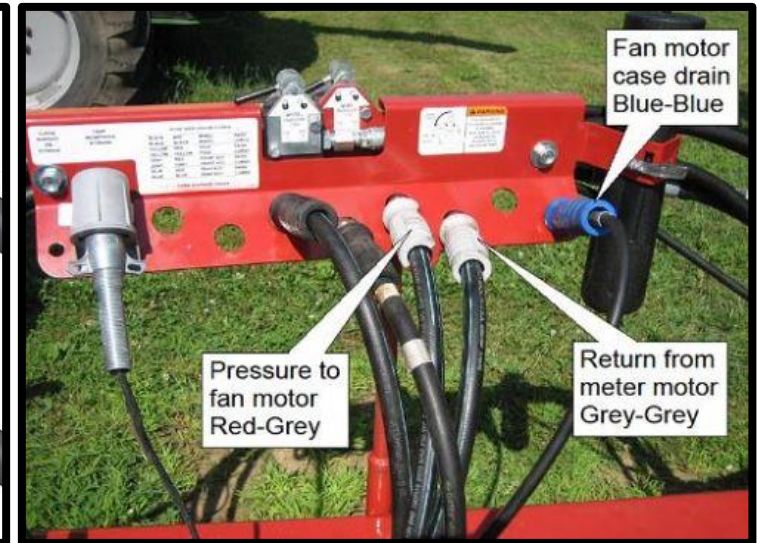
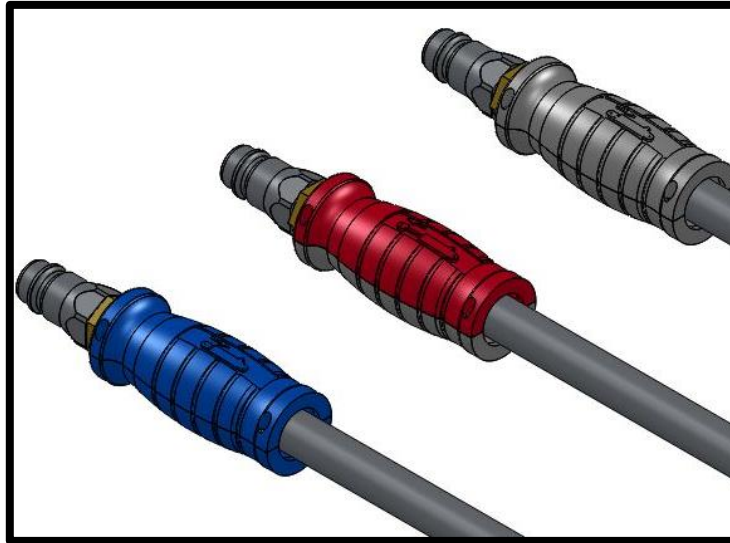
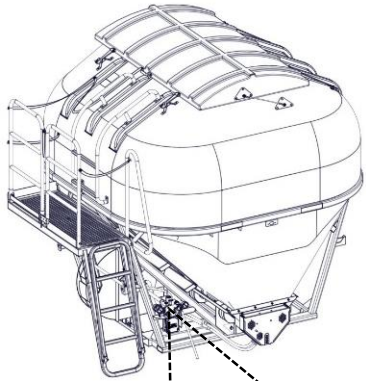

Install hoses in A000109/A000177 from tractor to corresponding ports shown:

Hookup case drain alarm to 12VDC power.

A000109:
8-12 Row – ½" Lines
(See Hydragrip color coordination).

A000177:
16 Row - ¾" hoses are for pressure and return.
½" hose is for the zero-pressure case drain.

* Hookup locations for a single section machine.

Mounting For 6 Ton Montag Dry Fertilizer Skid

Make sure the long side of the Cart Sub Frame is facing the rear of the Gladiator. Mount the Tank Skid so that the ends are flush with the ends of the Cart Sub Frame. Use the 5/8 NC x 4 U-bolts or weigh bars provided by Montag to clamp Tank Skid to Cart Sub Frame.

