

Components of A002176 – Kit – Gladiator 1210 Mount Gen 2

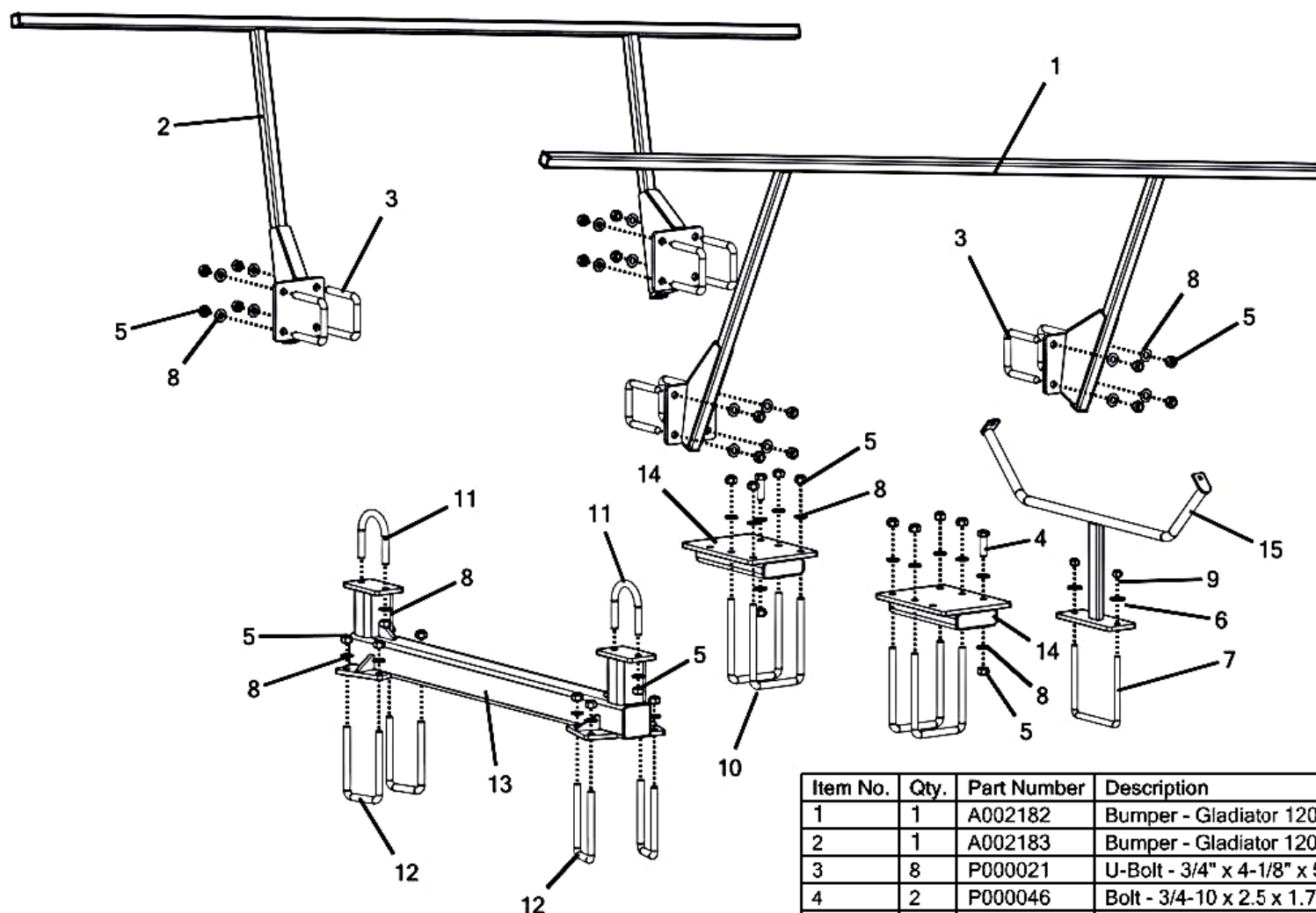

Item No.	Qty.	Part Number	Description
1	1	A002182	Bumper - Gladiator 1205 Gen II (Left)
2	1	A002183	Bumper - Gladiator 1205 Gen II (Right)
3	8	P000021	U-Bolt - 3/4" x 4-1/8" x 5-1/2"
4	2	P000046	Bolt - 3/4-10 x 2.5 x 1.75 Hex (GR 5 M/S FA)
5	38	P000061	Nut - 3/4-10 Hex Metal Lock (GR 5 M/S FA)
6	2	P000068	Washer - 5/8" USS Flat (1.75" OD) (GR 5 M/S FA)
7	1	P000300	U-Bolt - 5/8" x 8-1/8" x 8"
8	38	P000766	Washer - 3/4" SAE Flat (1.469" OD) (GR 5 M/S FA)
9	2	P002272	Nut - 5/8-11 Hex Metal Lock (GR 5 M/S FA)
10	4	P002318	U-Bolt - 3/4" x 6-1/8" x 9-1/2"
11	2	P002355	U-Bolt - 3/4" x 4-1/8" x 5-3/8"
12	4	P003014	U-Bolt - 3/4" x 4-1/8" x 8"
13	1	W002397	Mount - Front Gladiator 1205 Gen II
14	2	W002402	Mount - Rear Gladiator 1205 Gen II
15	1	W002413	Guide - Gladiator 1205 Gen II

Dimensions For Mounting Brackets

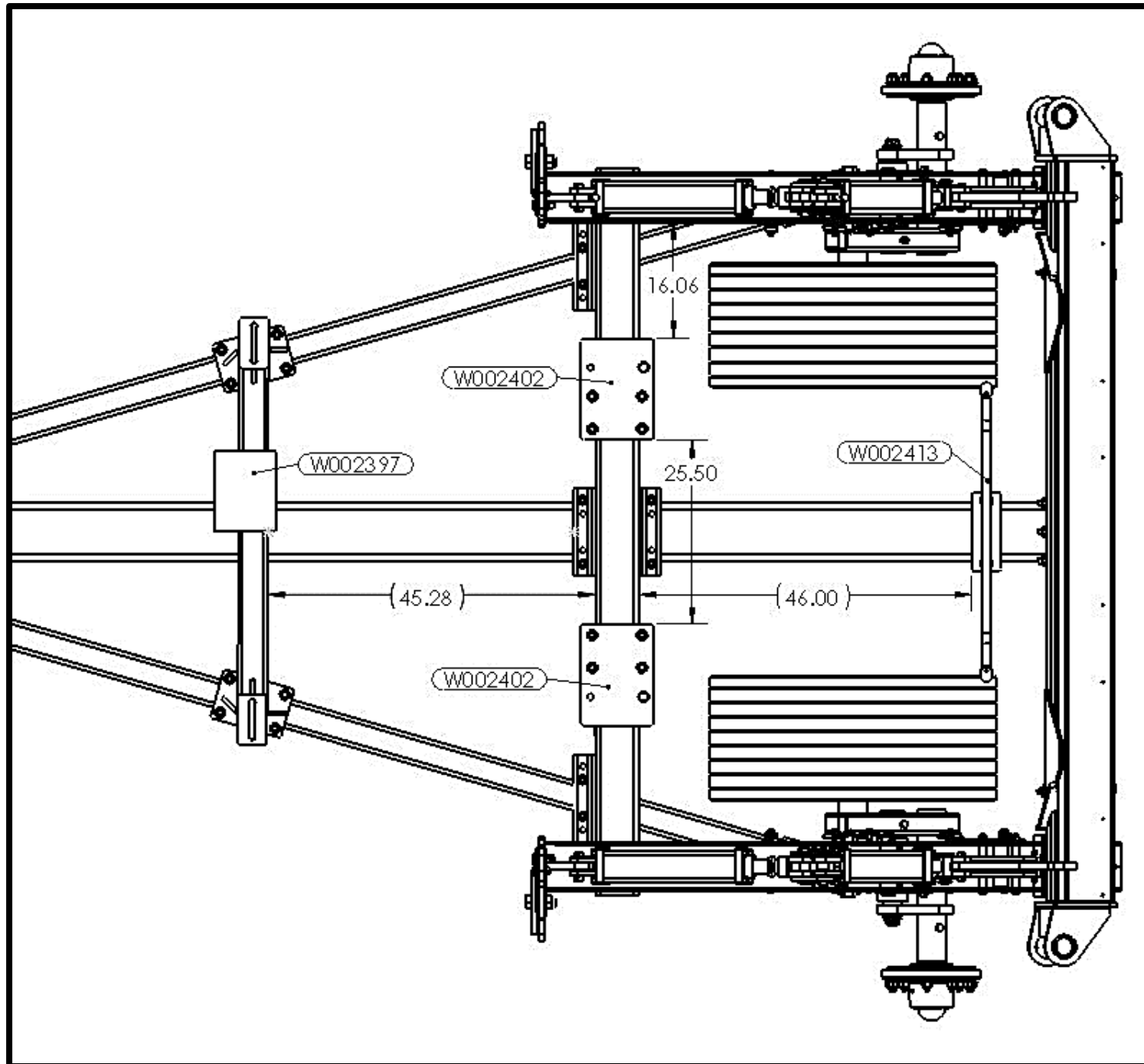

Gladiator 1210 Gen 2 Hydraulic Installation Instructions

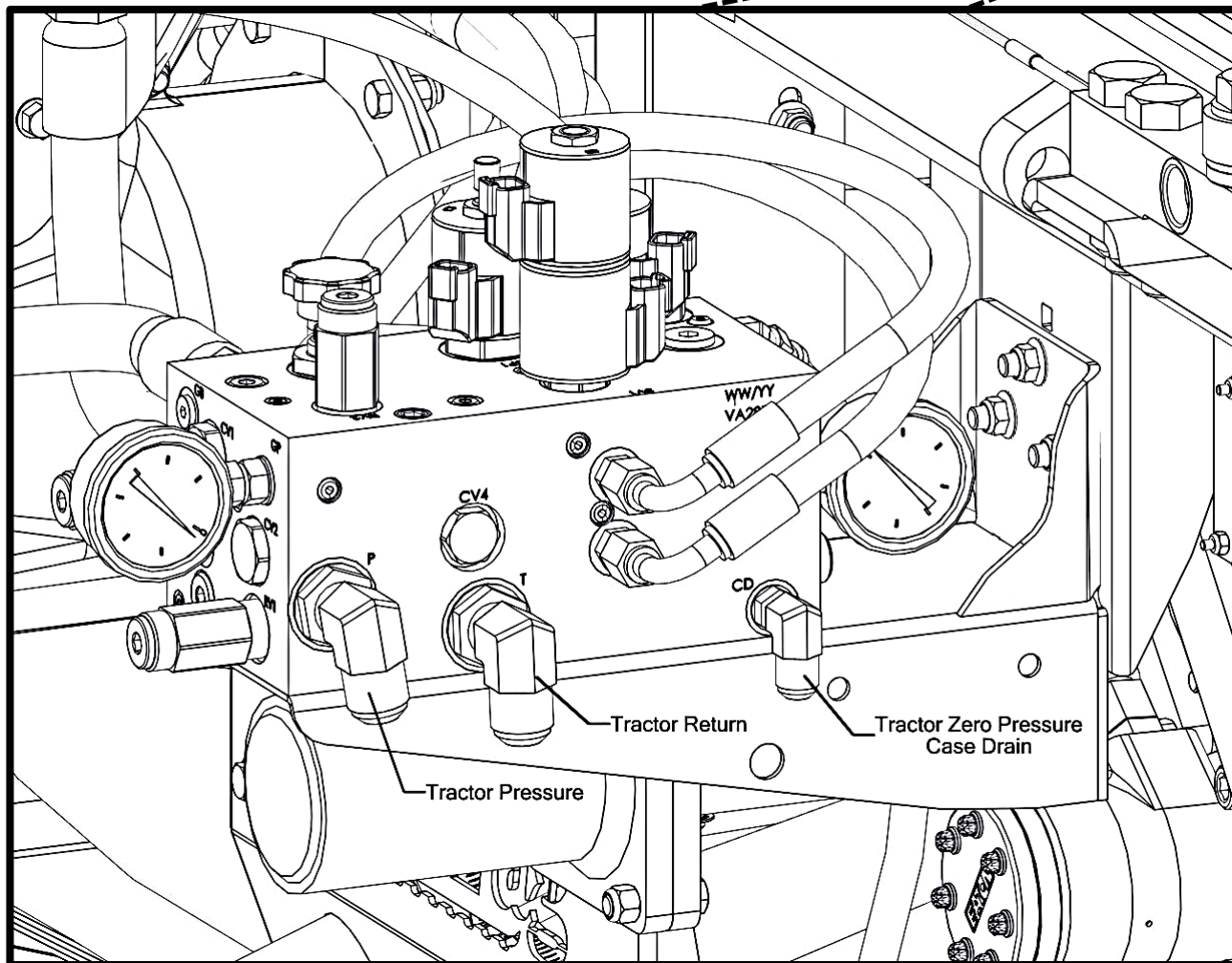
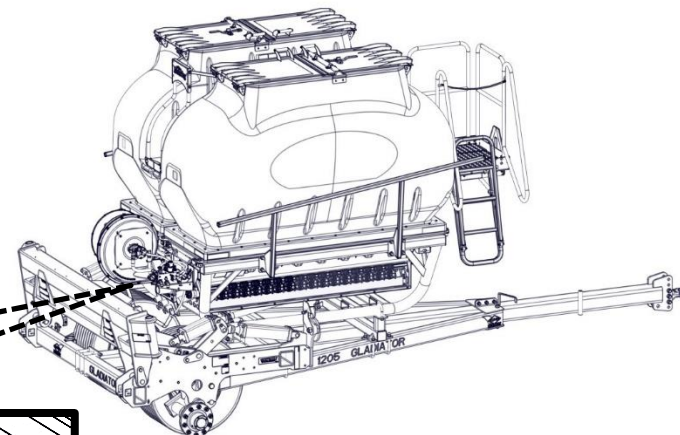

Install hoses in A000177 from tractor to corresponding ports shown.

$\frac{3}{4}$ " hoses are for pressure and return.

$\frac{1}{2}$ " hose is for the zero pressure case drain.

*Refer to manual for routing product distribution hoses.

Gen 2 / Gladiator 1210 Row Unit Assembly Instructions

HOSE LOCATIONS AND LENGTHS

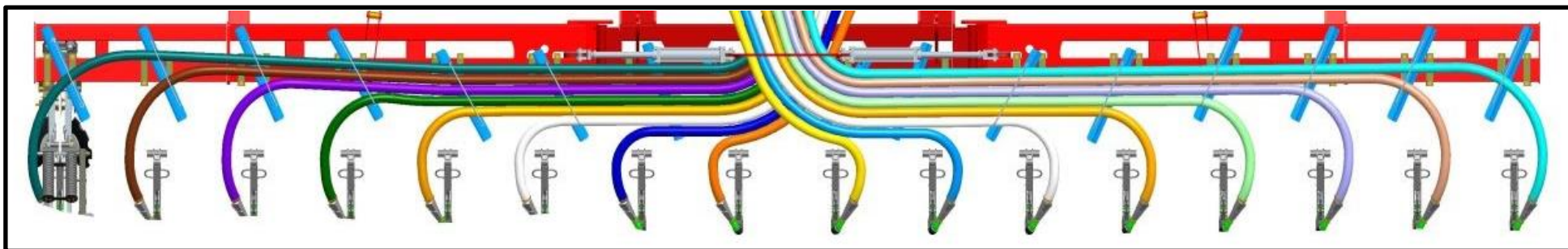
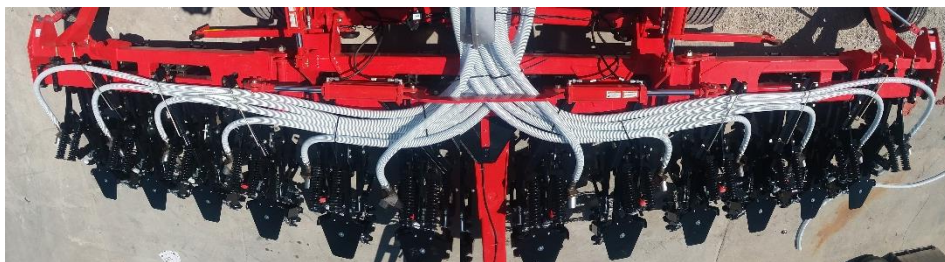

12 ROW	-	-	<u>1 - B</u> 20'5"	<u>2 - E</u> 18'	<u>3 - H</u> 17'2"	<u>4 - J</u> 15'	<u>5 - M</u> 12'	<u>6 - P</u> 9'4"	<u>7 - Q</u> 9'4"	<u>8 - N</u> 12'	<u>9 - K</u> 15'	<u>10 - I</u> 17'2"	<u>11 - F</u> 18'	<u>12 - C</u> 20'5"	-	-
16 ROW	<u>1 - B</u>	<u>2 - D</u>	<u>3 - F</u> 20'5"	<u>4 - H</u> 18'	<u>5 - J</u> 17'2"	<u>6 - L</u> 15'	<u>7 - N</u> 12'	<u>8 - P</u> 9'4"	<u>9 - Q</u> 9'4"	<u>10 - O</u> 12'	<u>11 - M</u> 15'	<u>12 - K</u> 17'2"	<u>13 - I</u> 18'	<u>14 - G</u> 20'5"	<u>15 - E</u>	<u>16 - C</u>

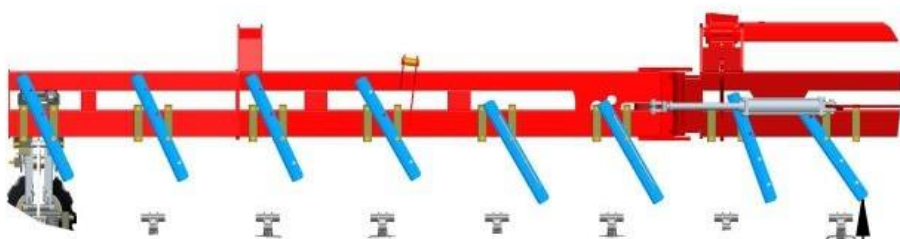

Assemble hose support straps to the cast clamp bolts so that the hoses can move forward when tripping over a rock. The center hose supports need to be extended farther back than the wings.

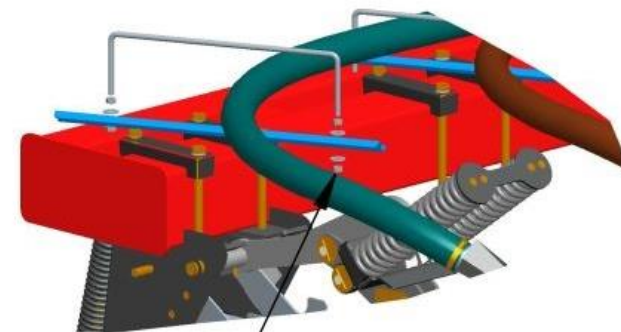
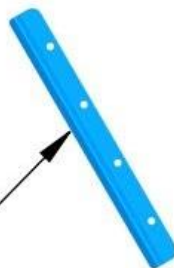

Use qty (4) 1/2" nuts and flat washers to mount U-bolts

MonTag Gen 2 / Gladiator 1210 12 Row Hose Routing Instructions

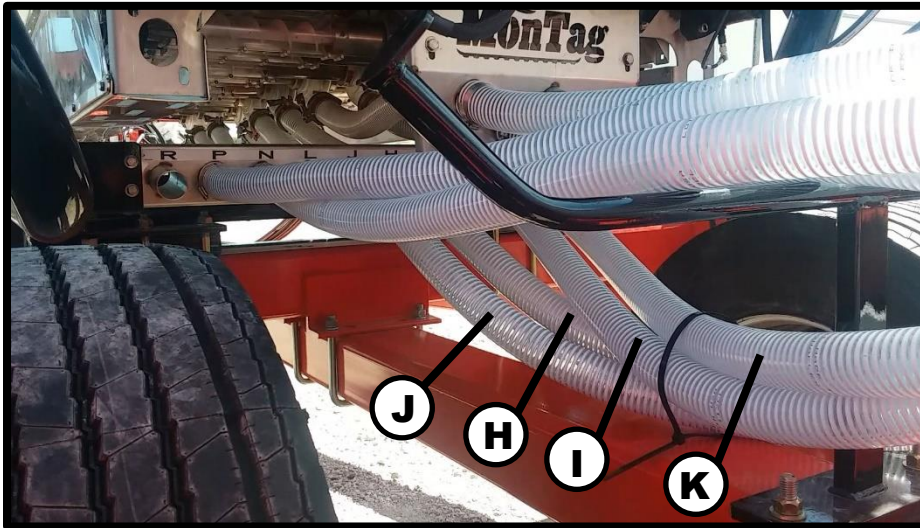

FOUR HOSES RUN UNDER THE SADDLE. NOTE THAT THEY CROSS OVER FROM ONE SIDE TO THE OTHER, AND ALL FOUR ARE ZIP TIED TOGETHER AS SHOWN.

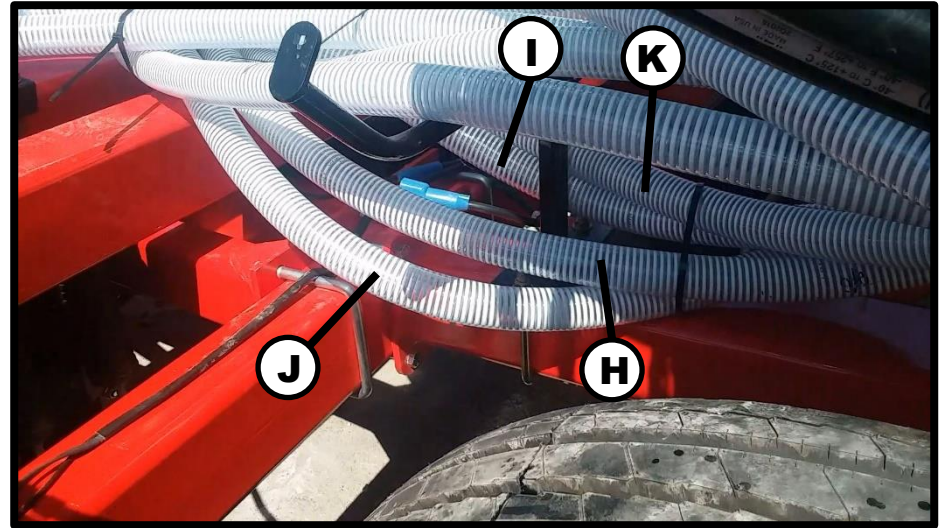

THE SAME HOSES, BUT FROM THE OTHER SIDE. NOTE THAT AFTER THE HOSES CROSS, THEY RUN ON EITHER SIDE OF THE SADDLE BEFORE CROSSING BACK OVER AGAIN.

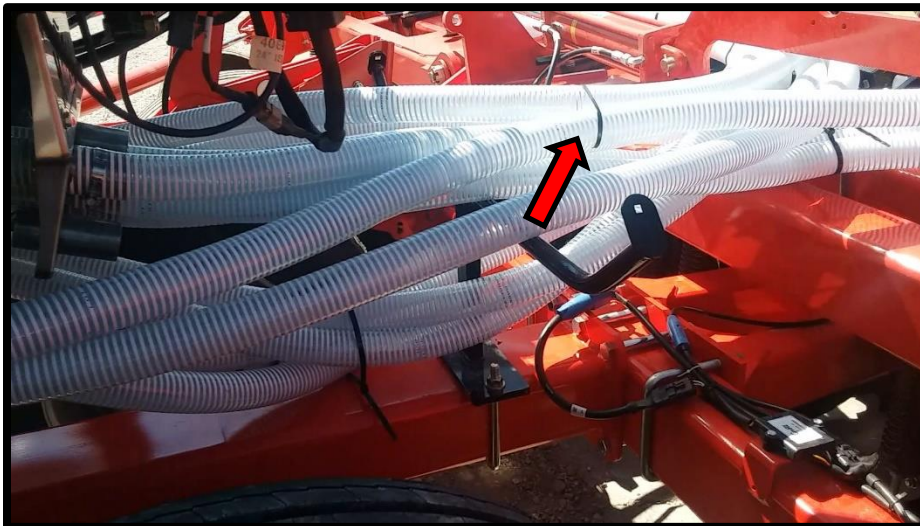

HOSES P AND Q ARE LOOSELY ZIP TIED TOGETHER NEAR THE PLACE WHERE THEY GO OVER THE SADDLE. SOME LOCATIONS MAY REQUIRE MULTIPLE ZIP TIES.



THE HOSES ARE ZIP TIED TOGETHER IN SEVERAL PLACES TO KEEP THEM IN PLACE WHEN THE TOOLBAR FOLDS AND UNFOLDS. SEE THE NEXT PAGE FOR MORE DETAIL.

Gen 2 / Gladiator 1210 12 Row Hose Routing Instructions ZIP TIE LOCATIONS

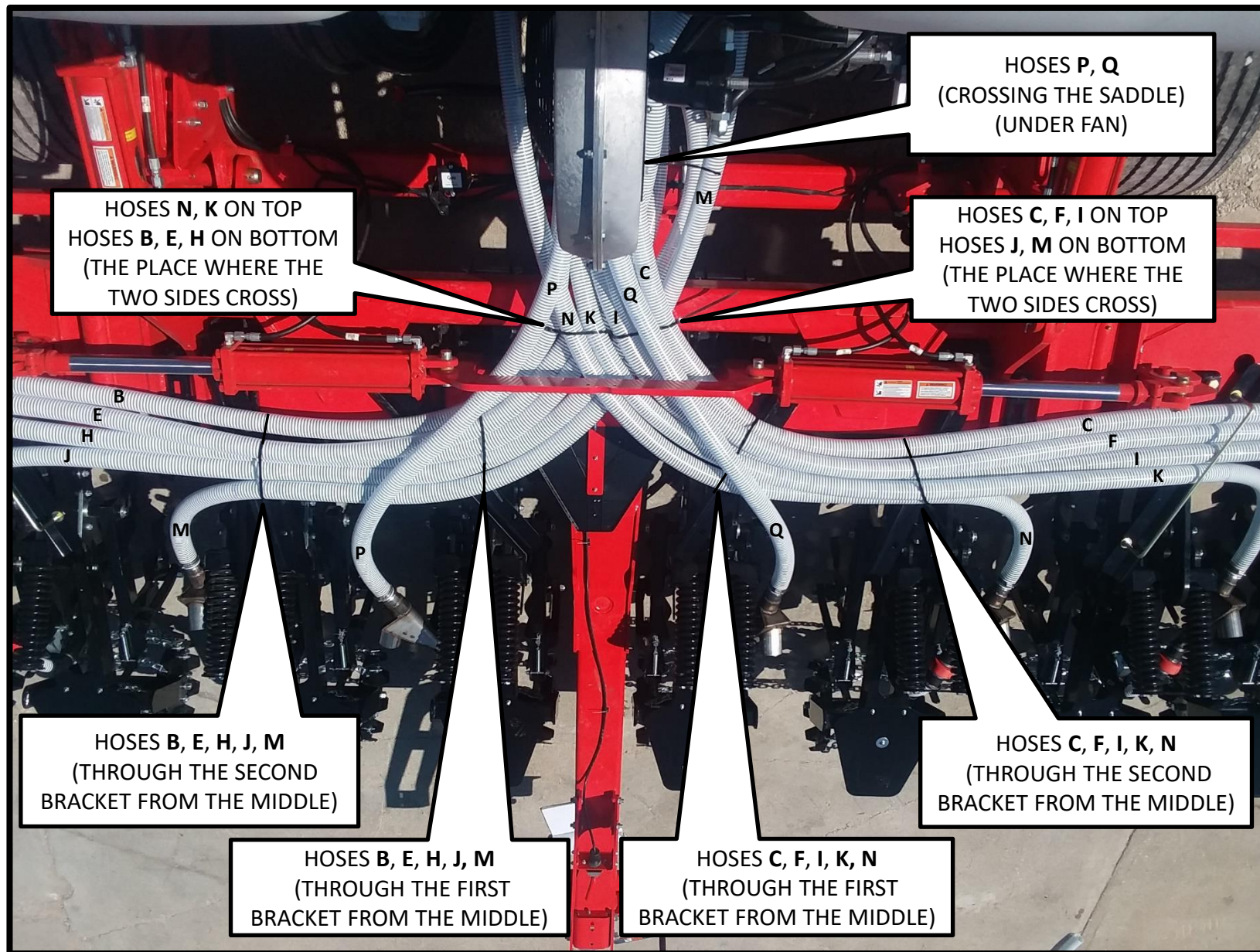

MonTag / Gladiator Row Unit Assembly Instructions

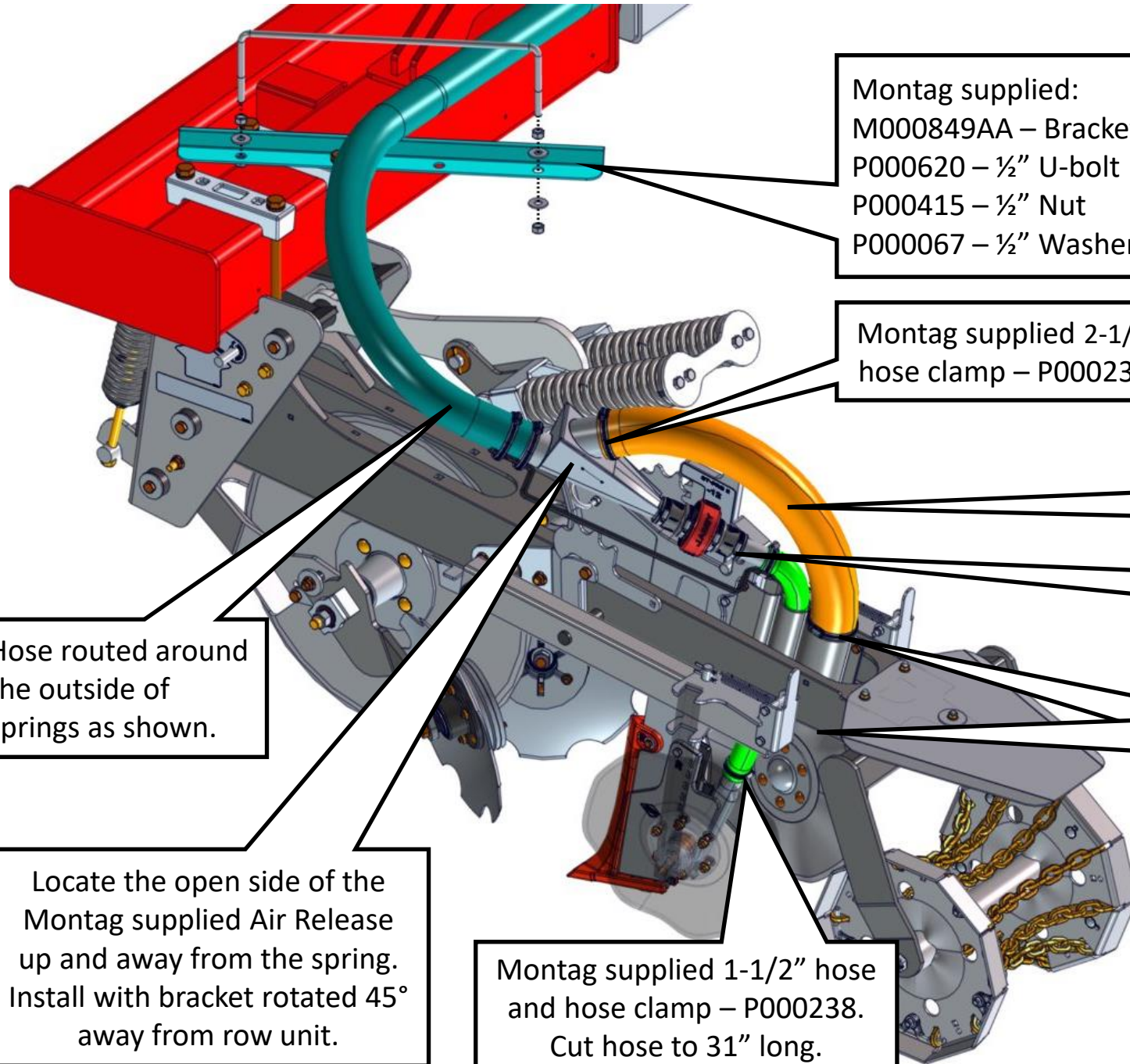

Montag supplied:
M000849AA – Bracket
P000620 – ½" U-bolt
P000415 – ½" Nut
P000067 – ½" Washer

Montag supplied 2-1/2"
hose clamp – P000239.

4 Row Mount Kit – K002538AA
6 Row Mount Kit – K002539AA
8 Row Mount Kit – K002397AA
12 Row Mount Kit – K002398AA
16 Row Mount Kit – K002399AA

Montag supplied
exhaust hose –
M004250.

Montag supplied
1-1/2" hose clamp –
P000238.

Montag supplied 2-1/2"
hose clamp - above and
below hose guide to
hold tube in place.

Hose routed around
the outside of
springs as shown.

Locate the open side of the
Montag supplied Air Release
up and away from the spring.
Install with bracket rotated 45°
away from row unit.

Montag supplied 1-1/2" hose
and hose clamp – P000238.
Cut hose to 31" long.

**SHOWN WITH
OPTIONAL J. ASSY
BLOCKAGE SENSOR**

MonTag / J. Assy / Gladiator Blockage Sensor Assembly Instructions

Refer to J. Assy install guide for setup and programming of monitor and sensors.

PROGRAM ALL SENSORS BEFORE INSTALLATION.

Install couplers as shown below and on following page.

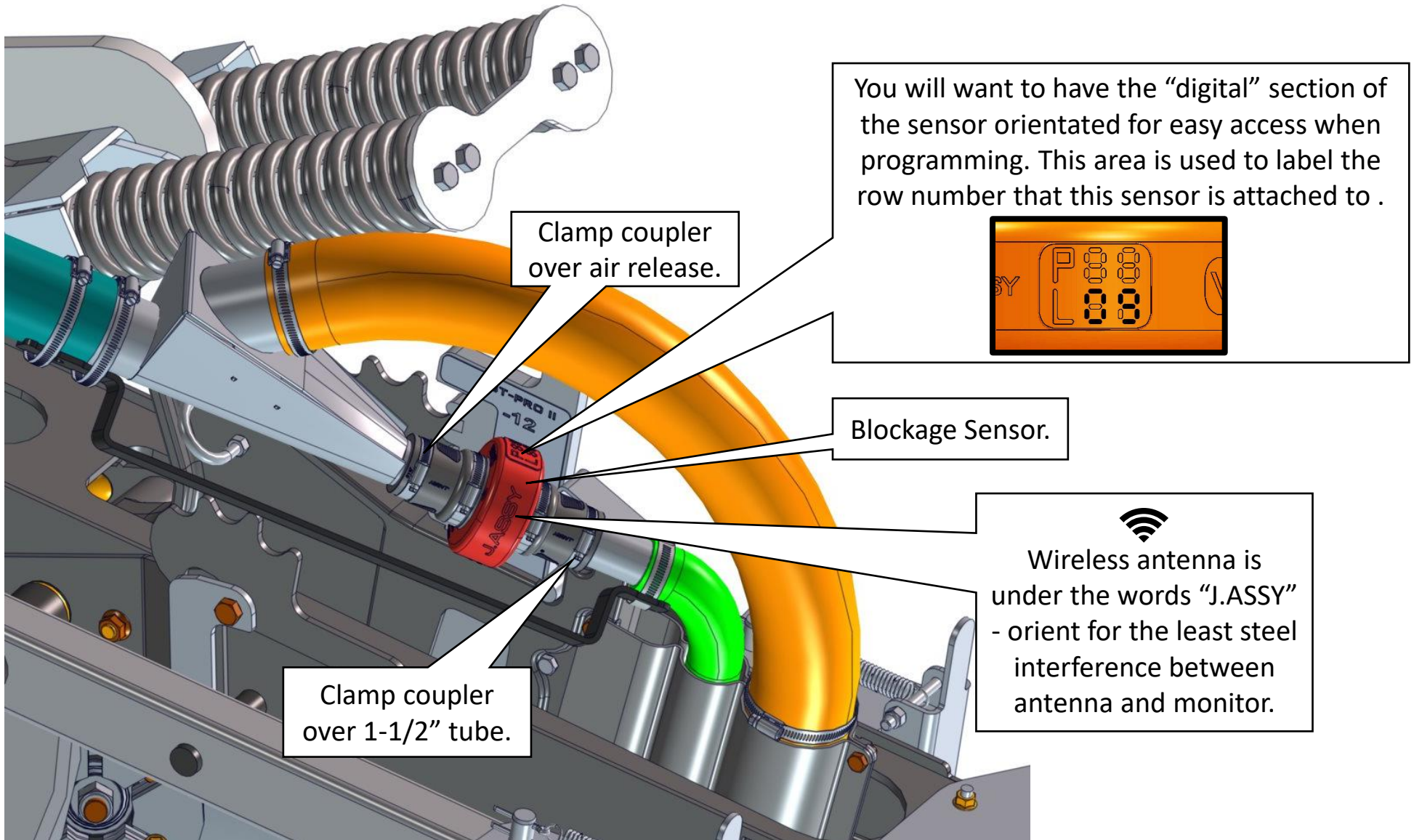

MonTag / J. Assy / Kuhn Wireless Monitoring Kits

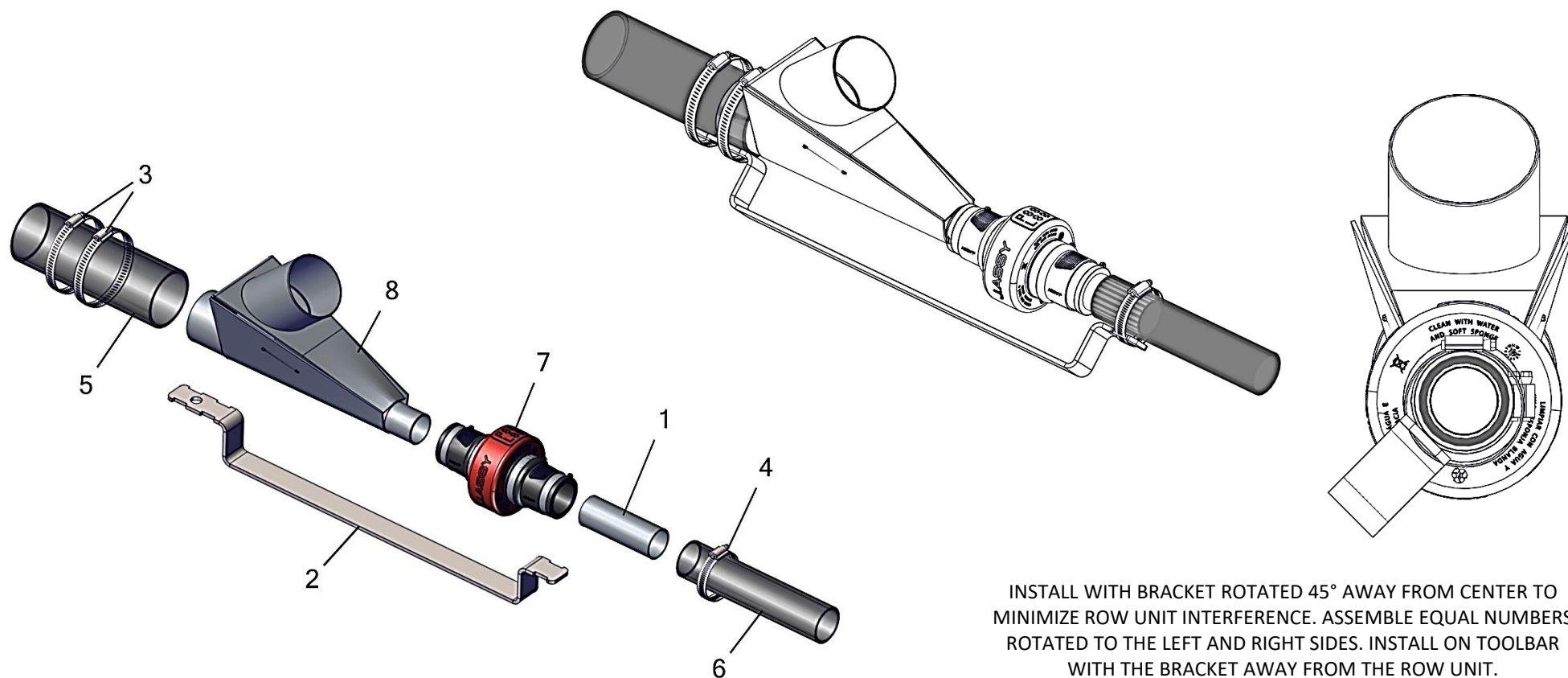

INSTALL WITH BRACKET ROTATED 45° AWAY FROM CENTER TO MINIMIZE ROW UNIT INTERFERENCE. ASSEMBLE EQUAL NUMBERS ROTATED TO THE LEFT AND RIGHT SIDES. INSTALL ON TOOLBAR WITH THE BRACKET AWAY FROM THE ROW UNIT.

Item No.	Qty	Part Number	Description
1	1	M000735	Tube - Hose Splice (1-1/2")
2	1	M003582	Bracket - J.Assy Blockage Sensor Stabilizer
3	2		Hose Clamp For Inlet Hose
4	1		Hose Clamp For Outlet Hose
7	1	P002397	Sensor - 1-1/2" X 1-1/2" Row Blockage (J. Assy)
5	1		Inlet Hose
6	1		Outlet Hose
8	1		Montag Air Release

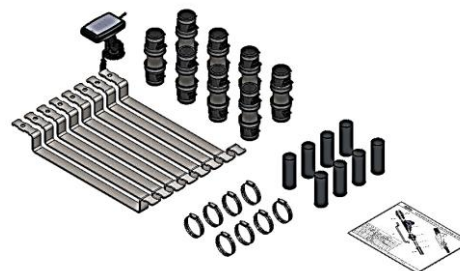

Sensor Kits (w/Stabilizer)

4 Row – 1.5" x 1.5" – K002465
 6 Row – 1.5" x 1.5" – K002466
 8 Row – 1.5" x 1.5" – K002460
 12 Row – 1.5" x 1.5" – K002461
 16 Row – 1.5" x 1.5" – K002462
 18 Row – 1.5" x 1.5" – K002463
 24 Row – 1.5" x 1.5" – K002464