

12- Row Gladiator Hose Routing For 6 Ton Montag Dry Fertilizer Skid

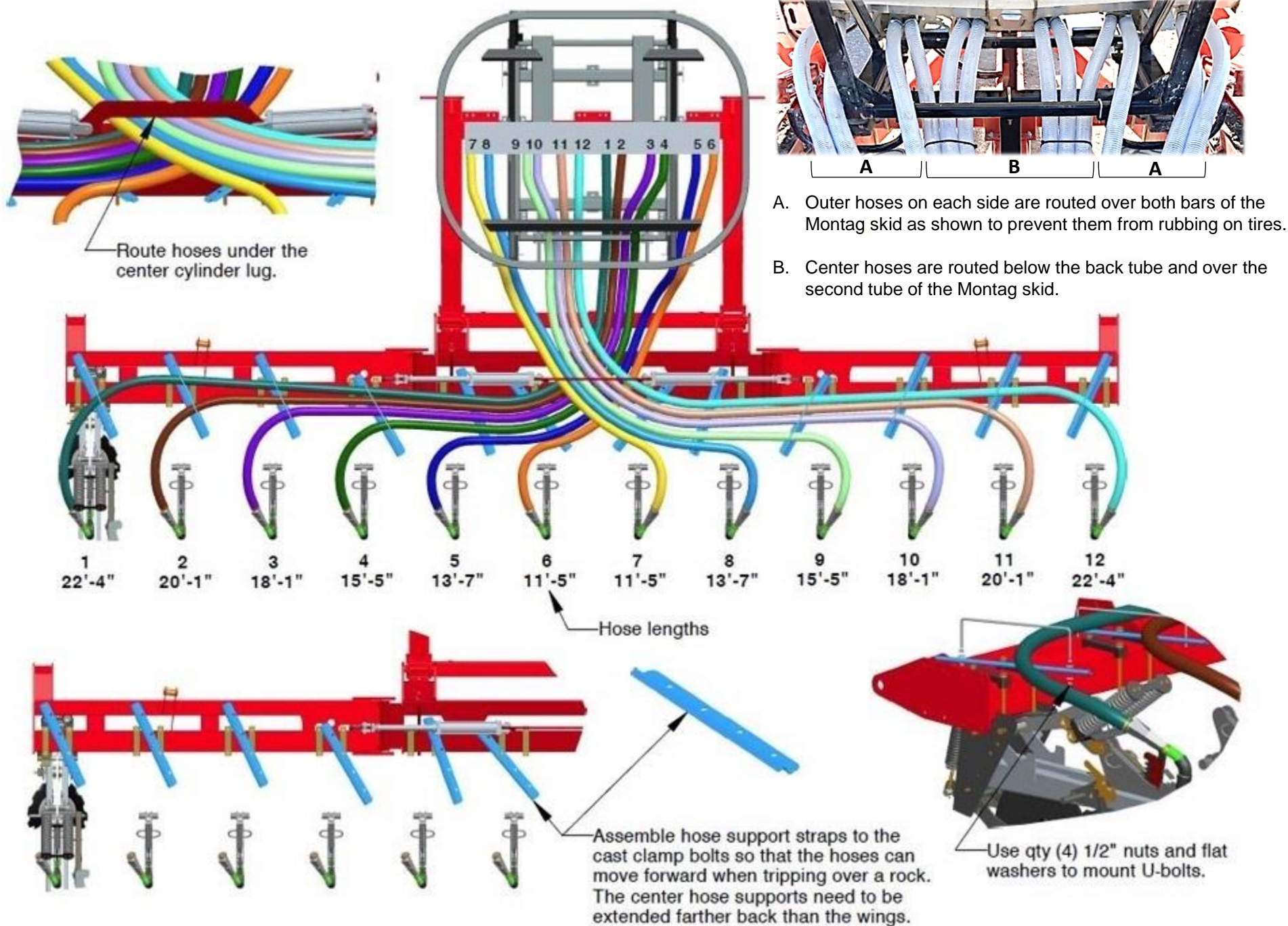

16- Row Gladiator Hose Routing For 6 Ton Montag Dry Fertilizer Skid

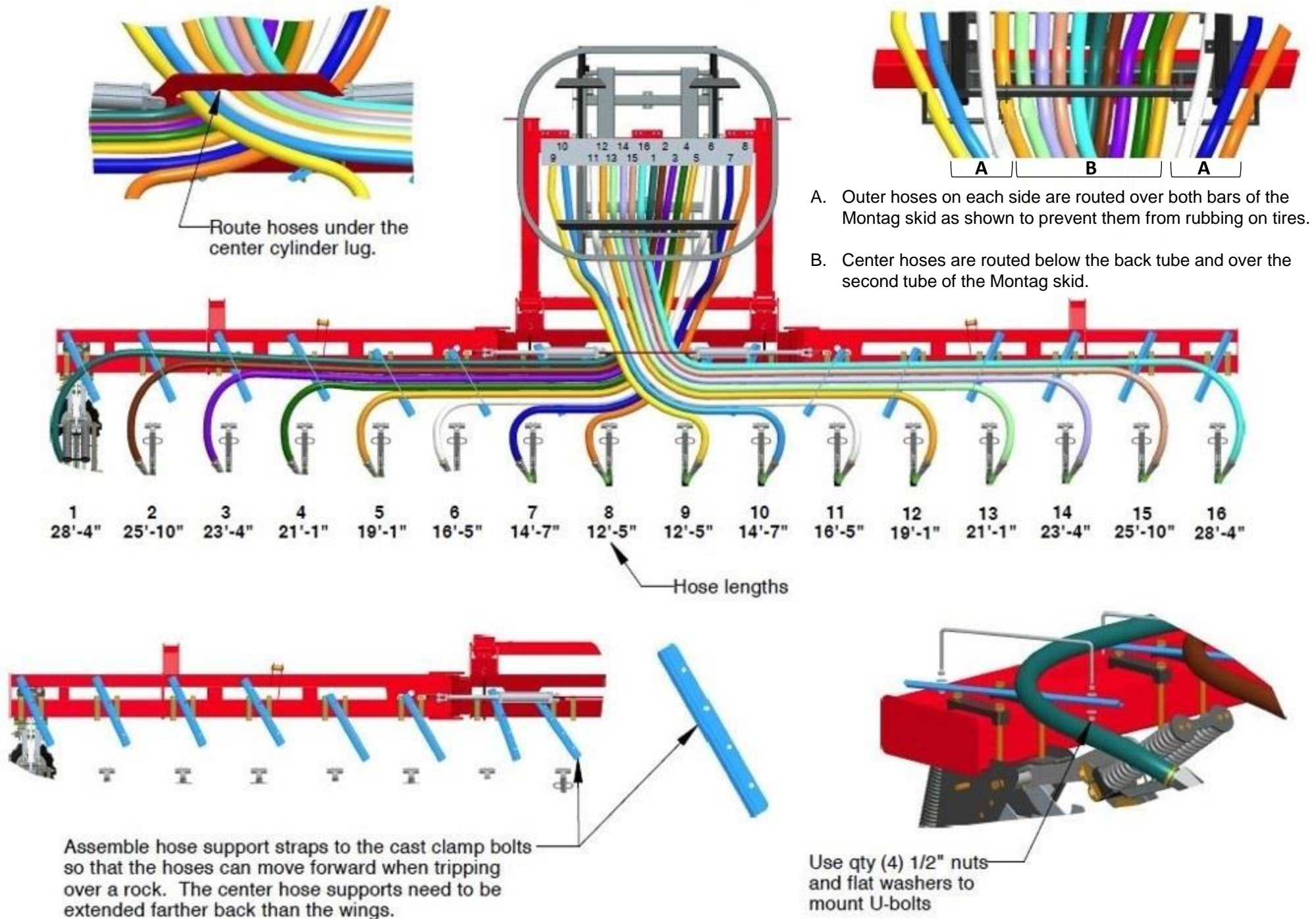

MonTag / Gladiator Row Unit Assembly Instructions

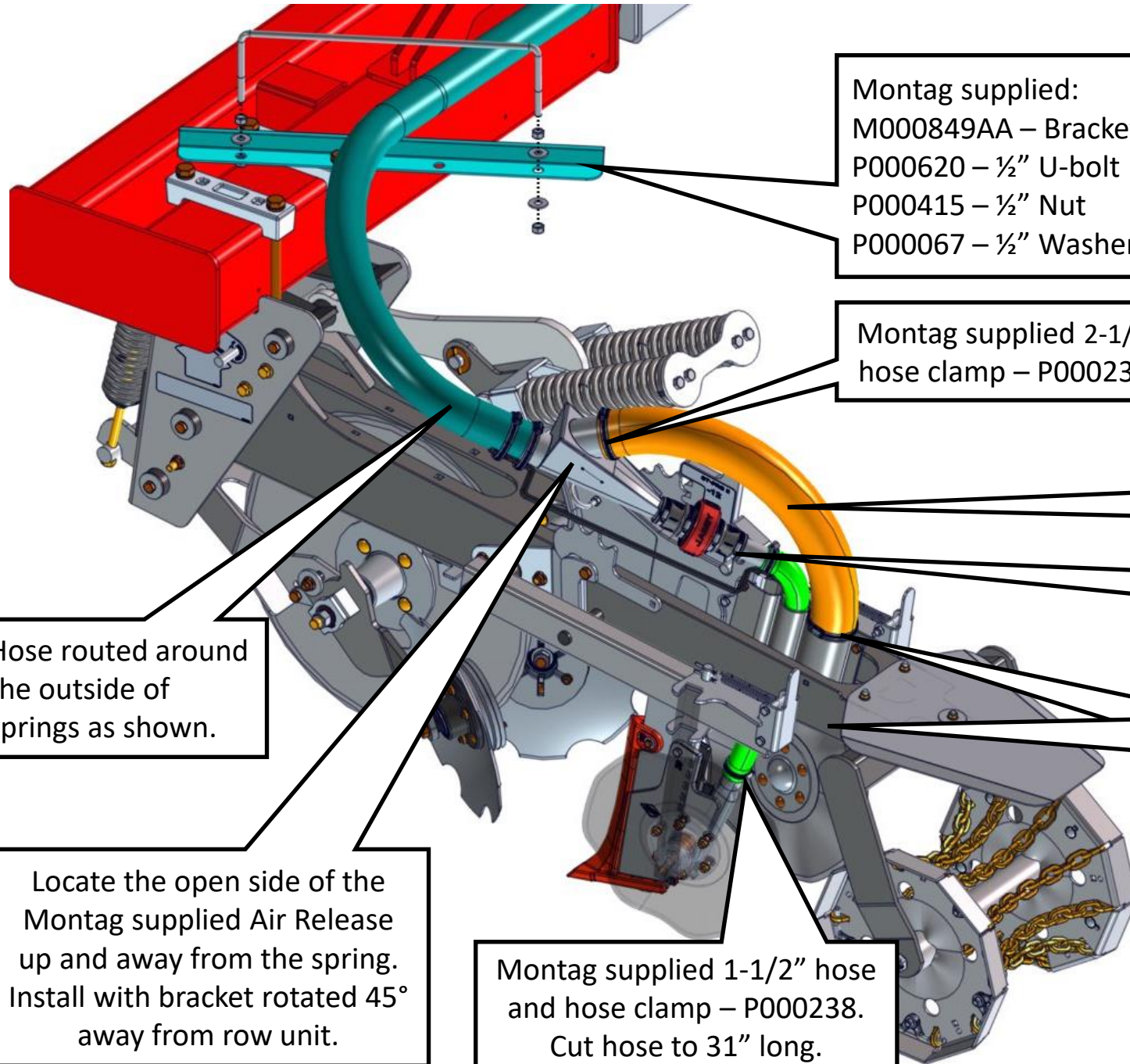

Montag supplied:
M000849AA – Bracket
P000620 – ½" U-bolt
P000415 – ½" Nut
P000067 – ½" Washer

Montag supplied 2-1/2"
hose clamp – P000239.

6 Row Mount Kit – K002391AA
8 Row Mount Kit – K002392AA
12 Row Mount Kit – K002393AA
16 Row Mount Kit – K002394AA

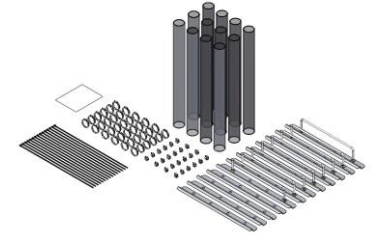

Montag supplied
exhaust hose –
M004250.

Montag supplied
1-1/2" hose clamp –
P000238.

Montag supplied 2-1/2"
hose clamp - above and
below hose guide to
hold tube in place.

Hose routed around
the outside of
springs as shown.

Locate the open side of the
Montag supplied Air Release
up and away from the spring.
Install with bracket rotated 45°
away from row unit.

Montag supplied 1-1/2" hose
and hose clamp – P000238.
Cut hose to 31" long.

**SHOWN WITH
OPTIONAL J. ASSY
BLOCKAGE SENSOR**

MonTag / J. Assy / Gladiator Blockage Sensor Assembly Instructions

Refer to J. Assy install guide for setup and programming of monitor and sensors.

PROGRAM ALL SENSORS BEFORE INSTALLATION.

Install couplers as shown below and on following page.

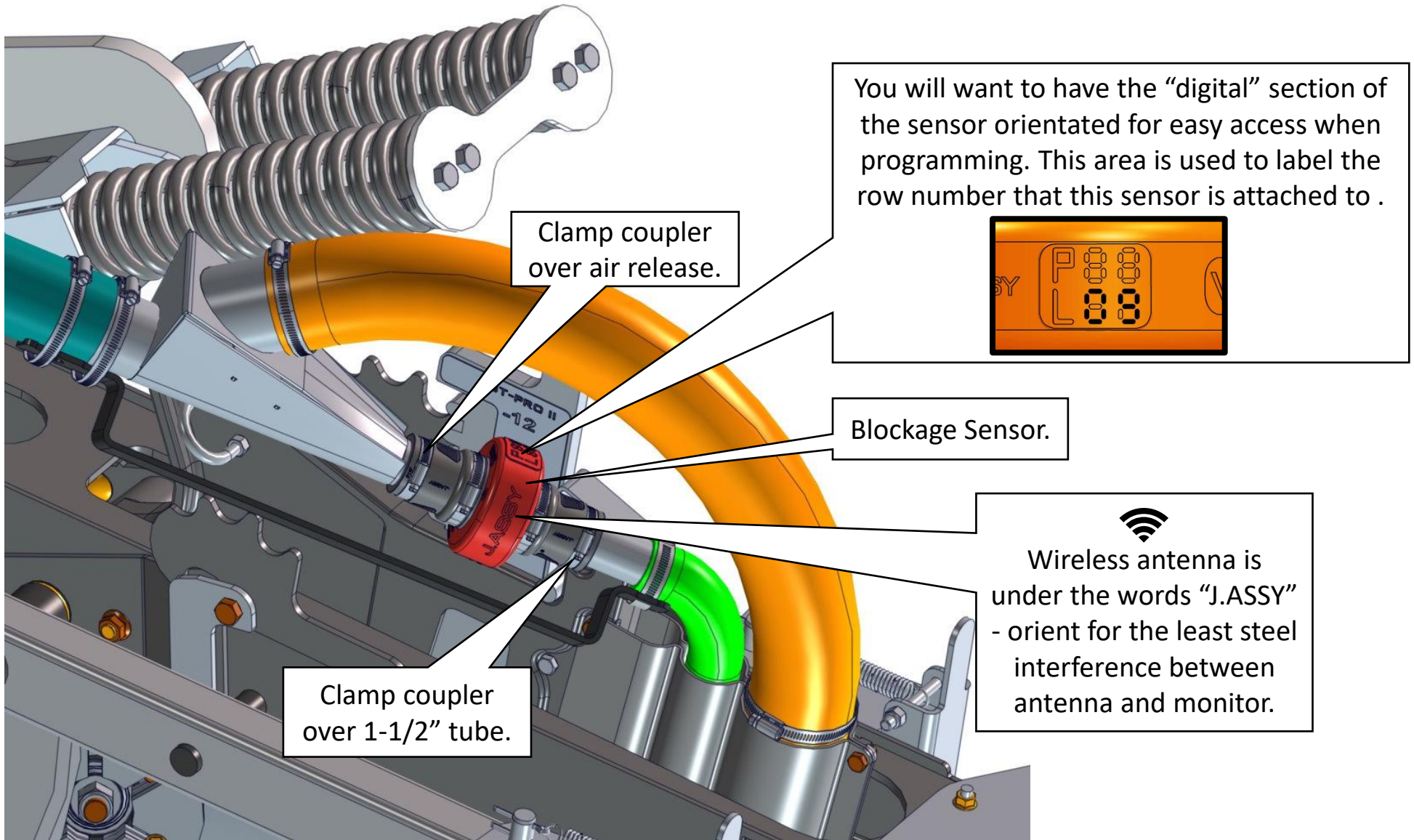

MonTag / J. Assy / Kuhn Wireless Monitoring Kits

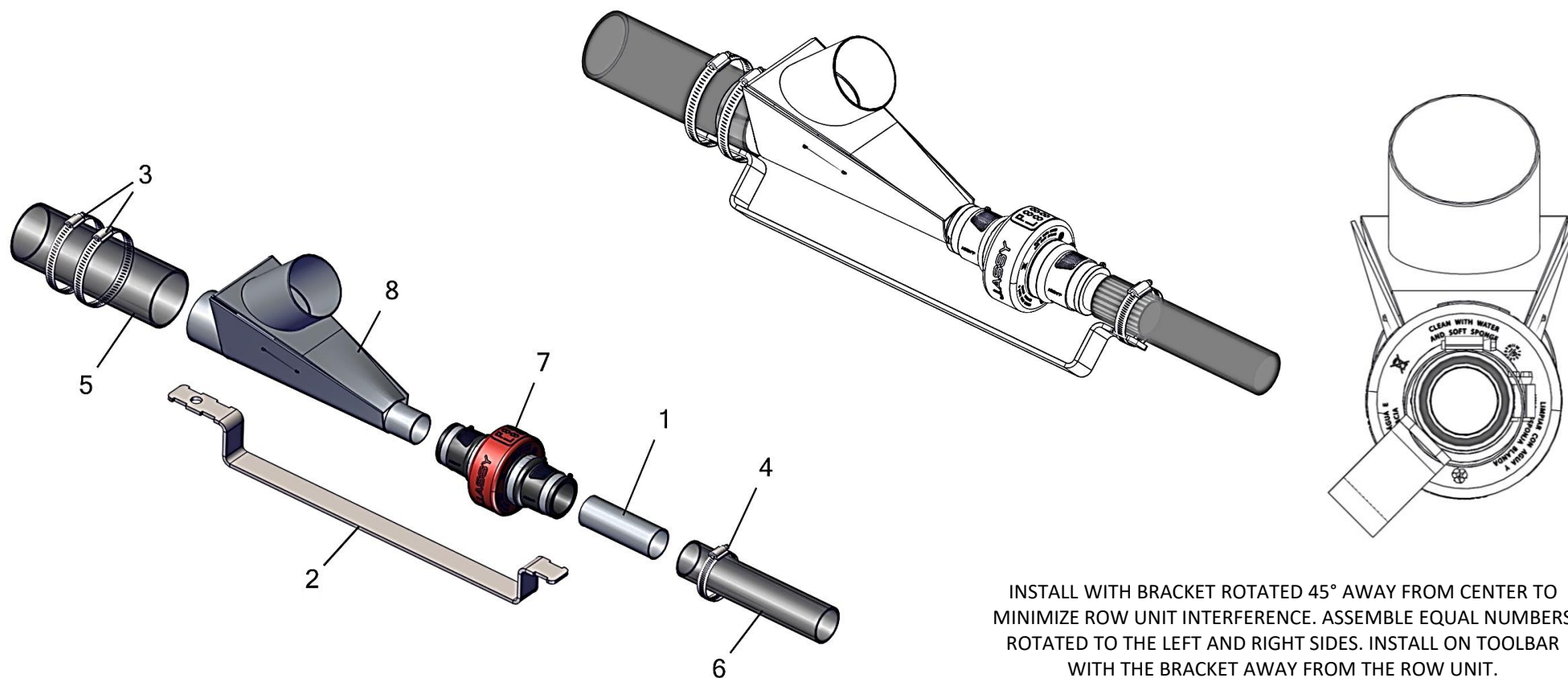

INSTALL WITH BRACKET ROTATED 45° AWAY FROM CENTER TO MINIMIZE ROW UNIT INTERFERENCE. ASSEMBLE EQUAL NUMBERS ROTATED TO THE LEFT AND RIGHT SIDES. INSTALL ON TOOLBAR WITH THE BRACKET AWAY FROM THE ROW UNIT.

Item No.	Qty	Part Number	Description
1	1	M000735	Tube - Hose Splice (1-1/2")
2	1	M003582	Bracket - J.Assy Blockage Sensor Stabilizer
3	2		Hose Clamp For Inlet Hose
4	1		Hose Clamp For Outlet Hose
7	1	P002397	Sensor - 1-1/2" X 1-1/2" Row Blockage (J. Assy)
5	1		Inlet Hose
6	1		Outlet Hose
8	1		Montag Air Release

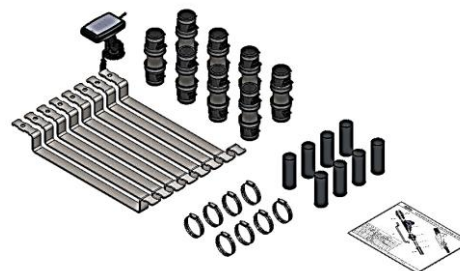

Sensor Kits (w/Stabilizer)

4 Row – 1.5" x 1.5" – K002465
 6 Row – 1.5" x 1.5" – K002466
 8 Row – 1.5" x 1.5" – K002460
 12 Row – 1.5" x 1.5" – K002461
 16 Row – 1.5" x 1.5" – K002462
 18 Row – 1.5" x 1.5" – K002463
 24 Row – 1.5" x 1.5" – K002464

HYDRAULIC COMPONENTS FOR MONTAG GEN I DRY SKID*

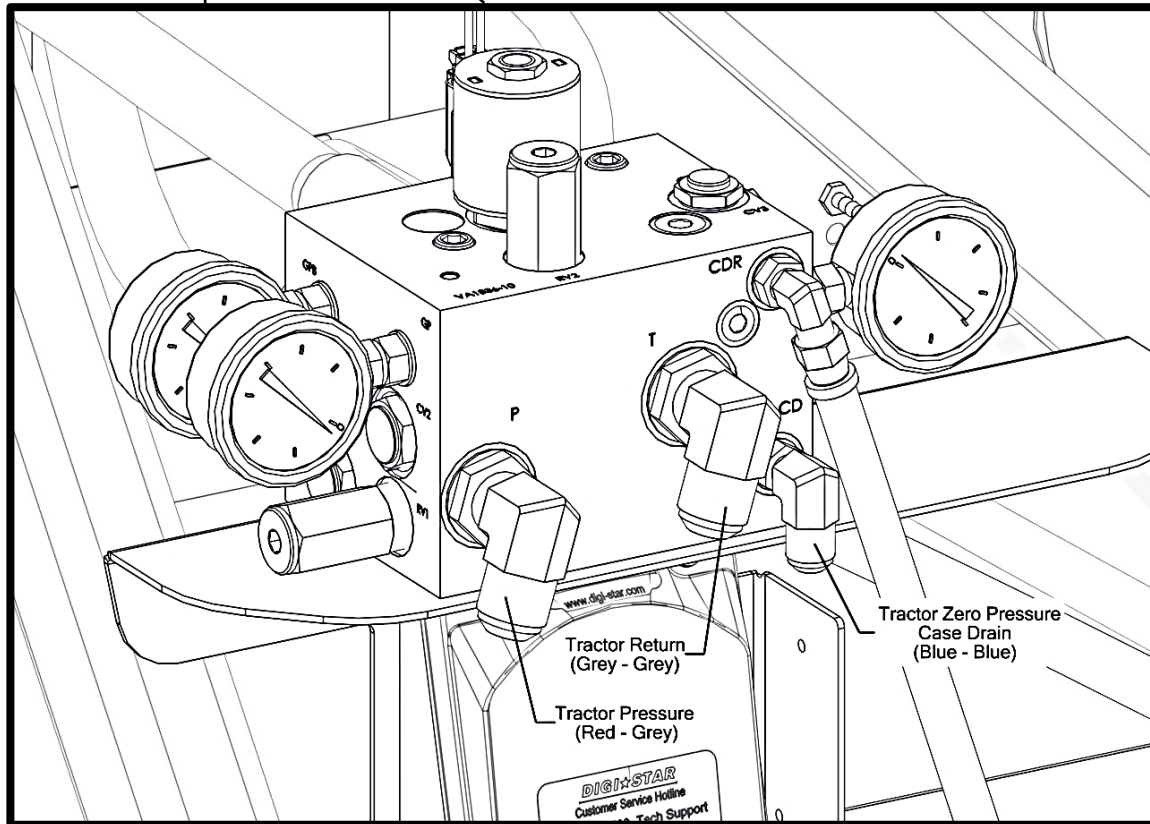
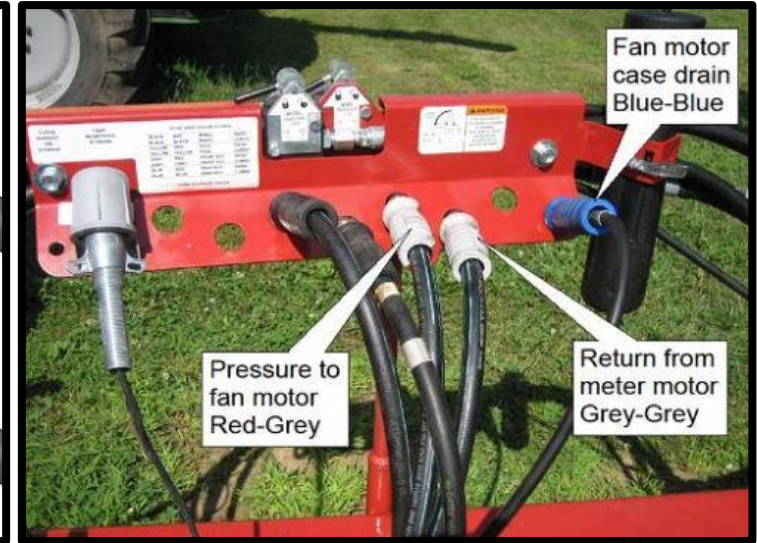
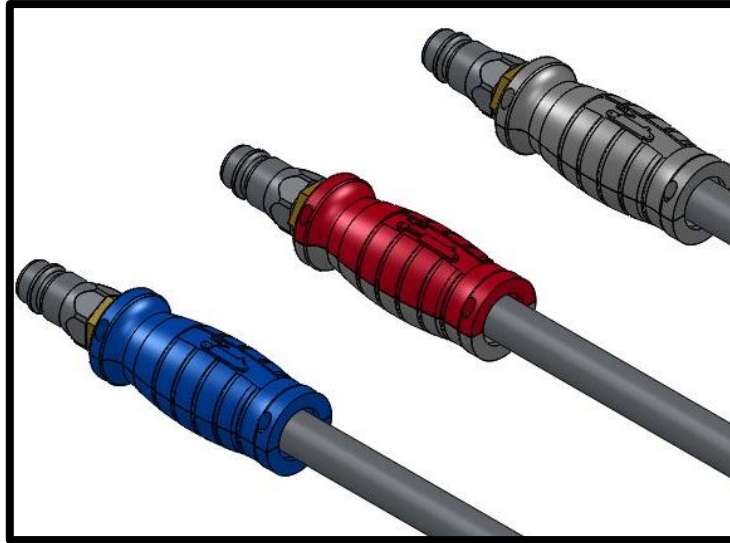
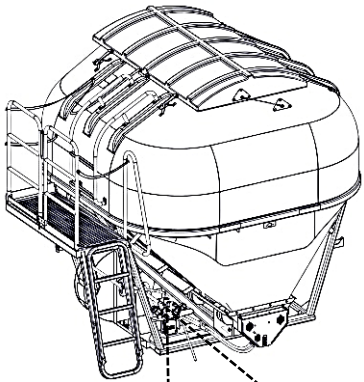

Install hoses in A000109/A000177 from tractor to corresponding ports shown:

Hookup case drain alarm to 12VDC power.

A000109:
8-12 Row – ½" Lines
(See Hydragrip color coordination).

A000177:
16 Row - ¾" hoses are for pressure and return.
½" hose is for the zero-pressure case drain.

* Hookup locations for a single section machine. For two-section machines (available in 16-row only), the return port is on the opposite side of the machine on the smaller hydraulic manifold.

Mounting For 6 Ton Montag Dry Fertilizer Skid

Make sure the long side of the Cart Sub Frame is facing the rear of the Gladiator. Mount the Tank Skid so that the ends are flush with the ends of the Cart Sub Frame. Use the 5/8 NC x 4 U-bolts or weigh bars provided by Montag to clamp Tank Skid to Cart Sub Frame.

